

**ADDENDUM 02 TO BID DOCUMENTS**

**FOR**

**GRAND ISLE AND VICINITY:  
WEST END BEACH NOURISHMENT PROJECT  
(BA-0210)**

**JEFFERSON PARISH, LOUISIANA**



**STATE OF LOUISIANA  
COASTAL PROTECTION AND RESTORATION  
AUTHORITY**

**AUGUST 24, 2020**

## **ADDENDUM 02 TO BID DOCUMENTS**

**Grand Isle and Vicinity: West End Beach Nourishment Project**

**(BA-0210)**

**The clarifications and revisions in this addendum supersede the requirements in the Bid Documents dated August 2020. The Successful bidder will be issued a complete revised set of plans and specifications. Bidders shall acknowledge receipt of this addendum in the Louisiana Public Work Bid Form.**

**Bidders shall acknowledge receipt of this addendum in the Louisiana Public Work Bid Form.**

**1. PRE-BID PRESENTATION**

The Presentation for the Pre-Bid Conference is provided in PDF format in Appendix A of the Addendum.

**2. NON-MANDATORY PRE-BID ATTENDANCE RECORD**

The Attendance Record for the Non-Mandatory Pre-Bid Conference is attached in Appendix B of the Addendum.

**ADDENDUM 02 TO BID DOCUMENTS**

**Grand Isle and Vicinity: West End Beach Nourishment Project**

**(BA-0210)**

**APPENDIX A: PRE-BID PRESENTATION**

# **GRAND ISLE AND VICINITY: WEST END BEACH NOURISHMENT PROJECT (BA-0210)**

## **Non-Mandatory Pre-Bid Conference**



# Project Background



# Grand Isle and Vicinity:

## West End Breakwaters and Beach Nourishment

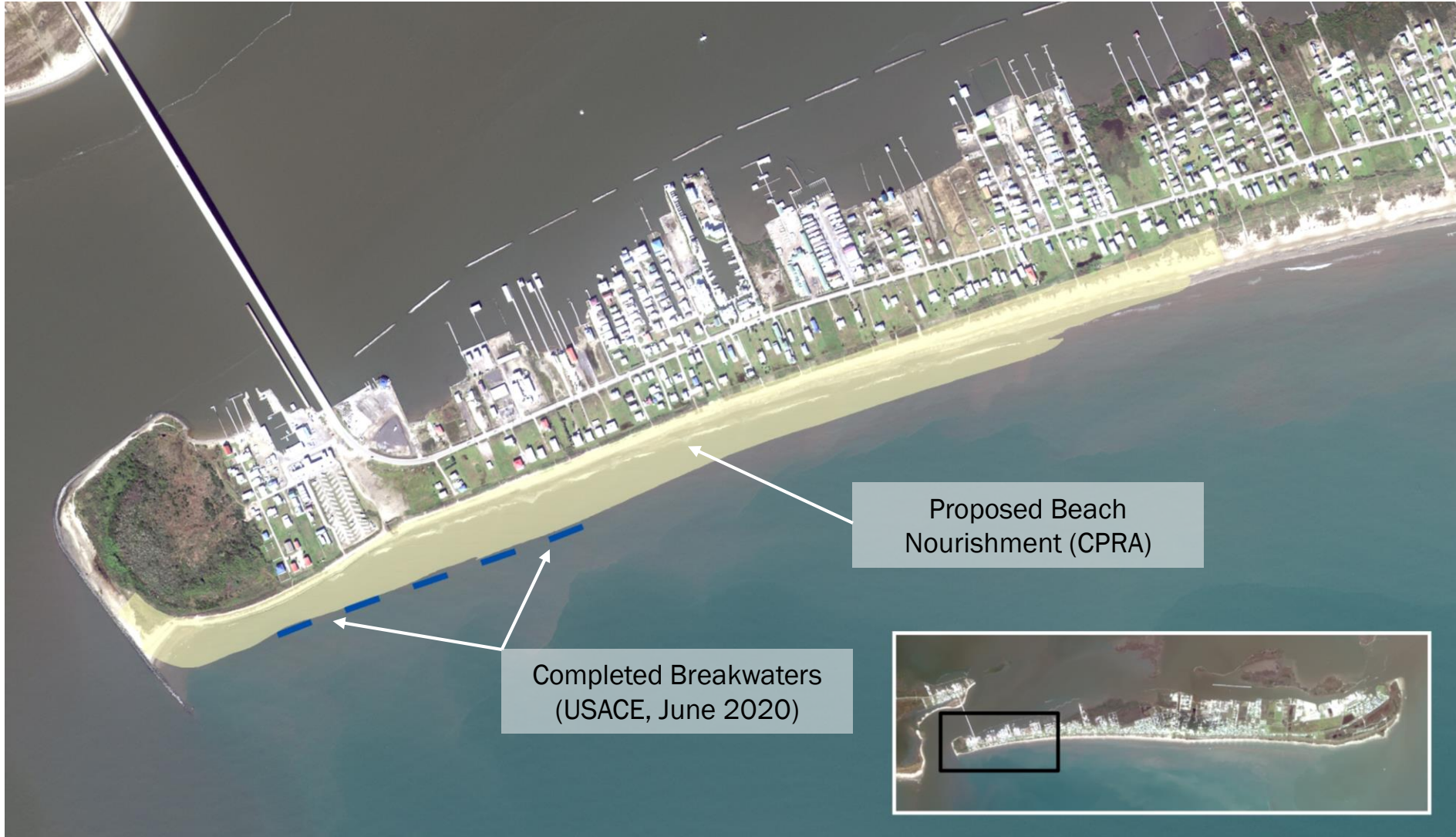



# Existing Conditions: Sta. 02+88

Looking Eastward





# Existing Conditions: Sta. 10+82

Looking Eastward





# Existing Conditions: Sta. 40+75

## Looking Westward





# Existing Conditions: Sta. 40+75

Looking Eastward





# Existing Conditions: Sta. 50+75

Looking Westward





# Existing Conditions: Sta. 60+75

Looking Westward





# Existing Conditions: Sta. 70+75

Looking Westward



# Notice to Bidders



# Pre-Bid and Jobsite Visit

- Virtual Pre-Bid Conference is non-mandatory/attendance not required to submit a bid.
- Please submit name, company, contact information in the Chat function of Zoom.
- Jobsite visit is not mandatory and will not be facilitated by CPRA
- Contact Travis Byland (225-342-6750) for information on access to the jobsite

# Bid Procedures

- Sealed bids will be received at CPRA (150 Terrace Ave, Baton Rouge, LA 70802) until 11:00am CT Friday August 28, 2020
- Bid Opening will be a virtual meeting through Zoom; link will be distributed via addendum
- Emergency Bid Provisions
- Bidder Questions
  - Submit to [cpa.bidding@la.gov](mailto:cpa.bidding@la.gov) by COB August 25<sup>th</sup>
  - CPRA will provide responses by COB August 26<sup>th</sup>



# Overview of Plans

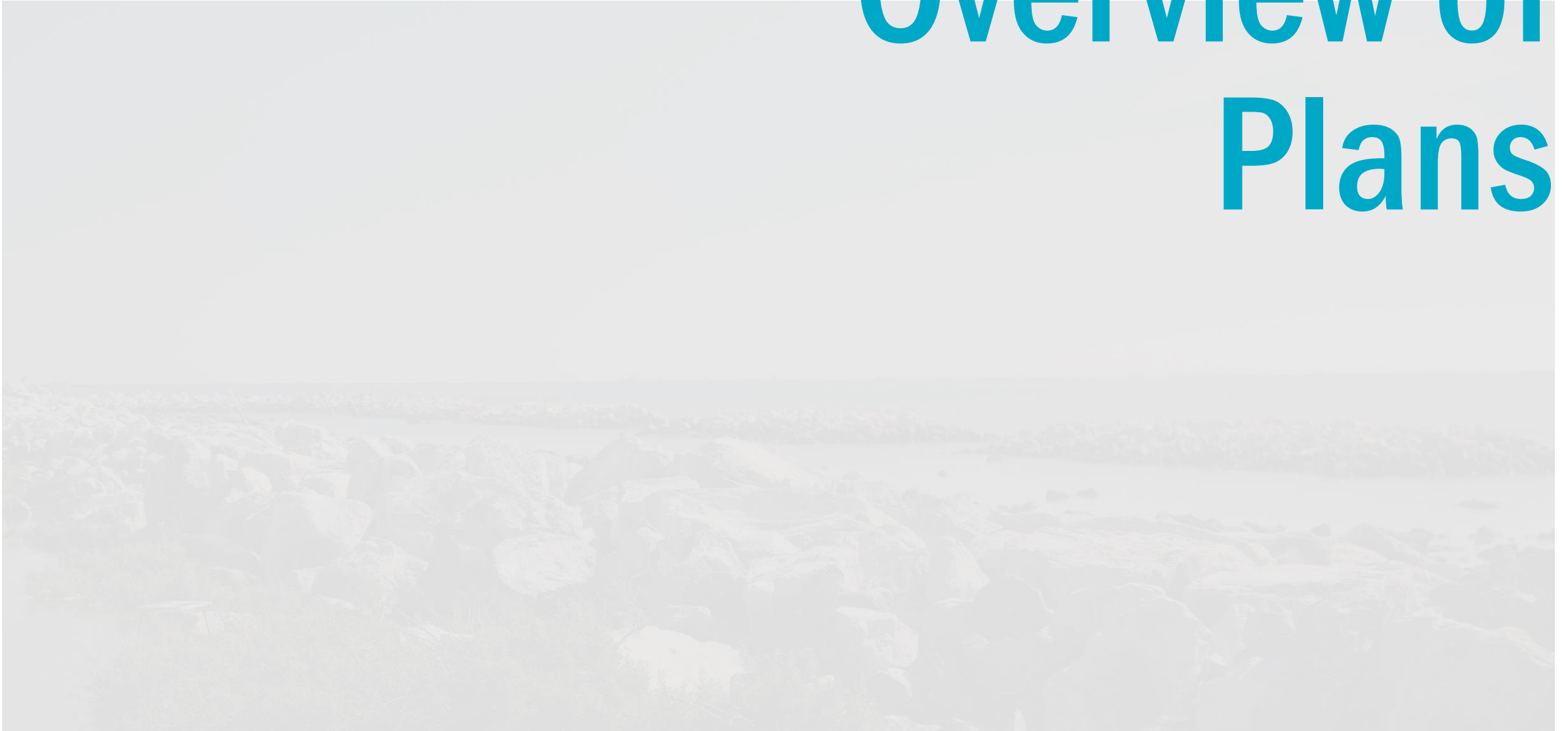

# Sheet 3 – Project Layout

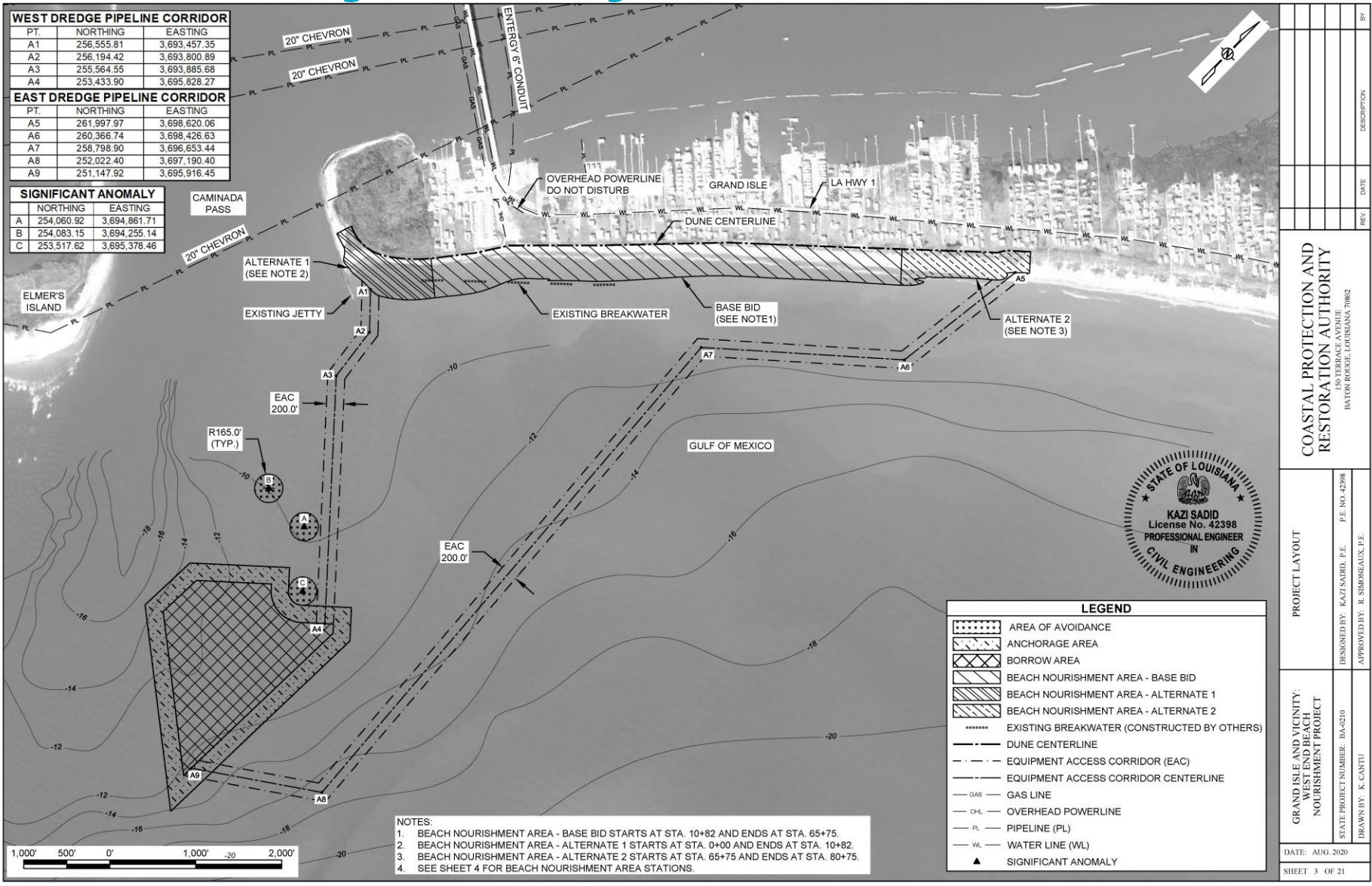

# Sheet 4 – Design Survey Layout

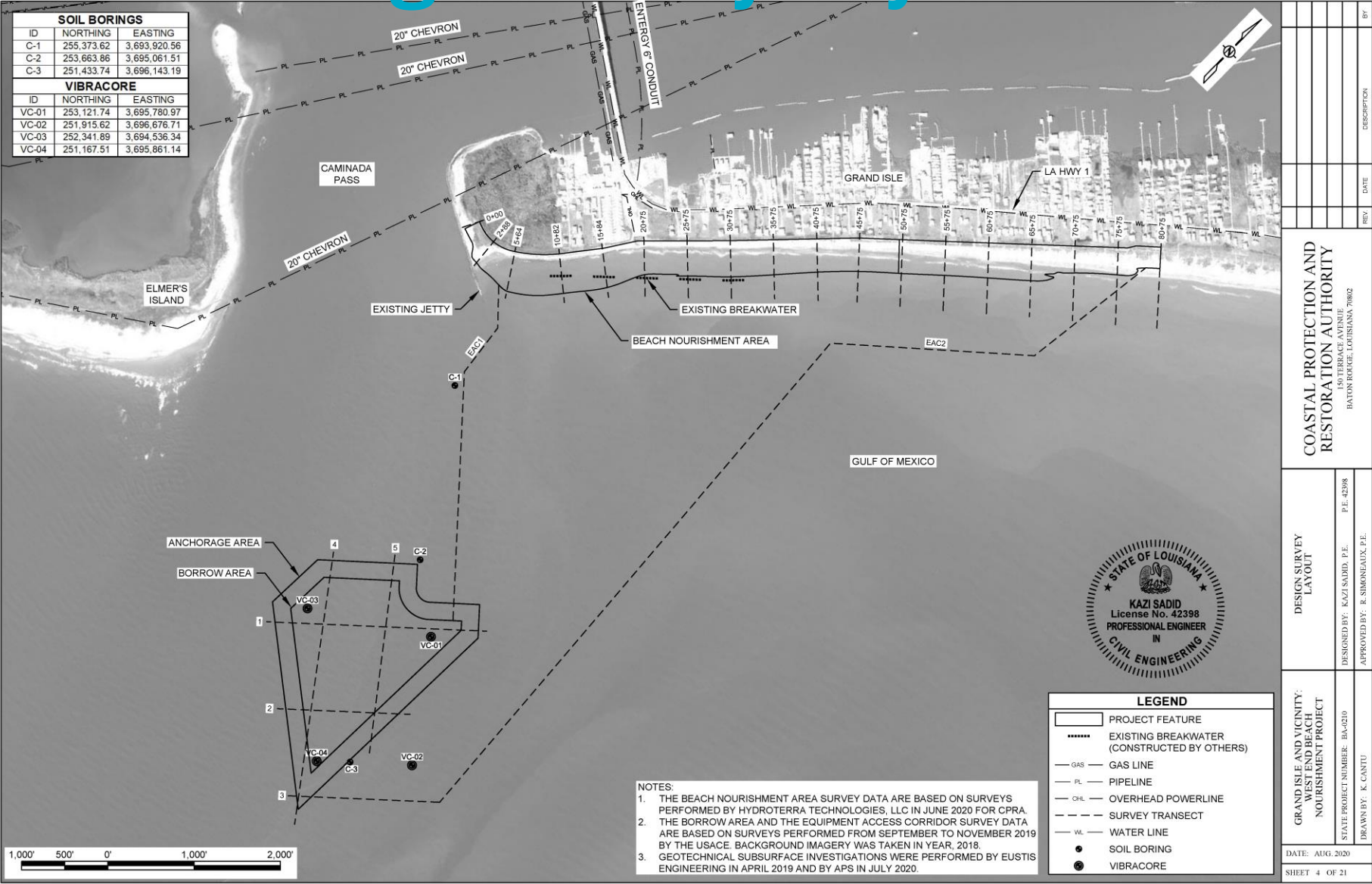



# Sheet 5 – Dune and Beach Planview

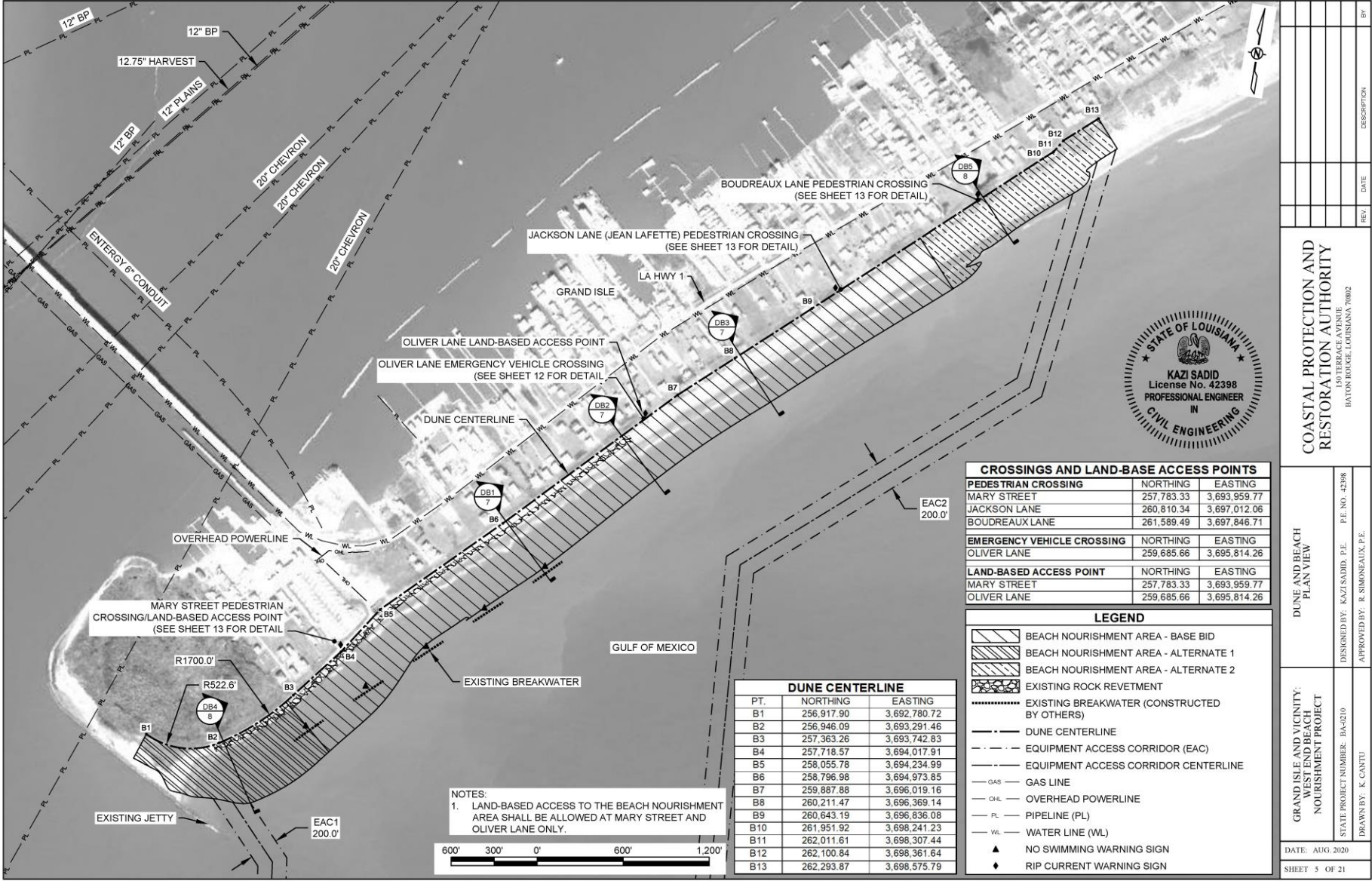



# Sheet 7 – Base Bid Typical Section

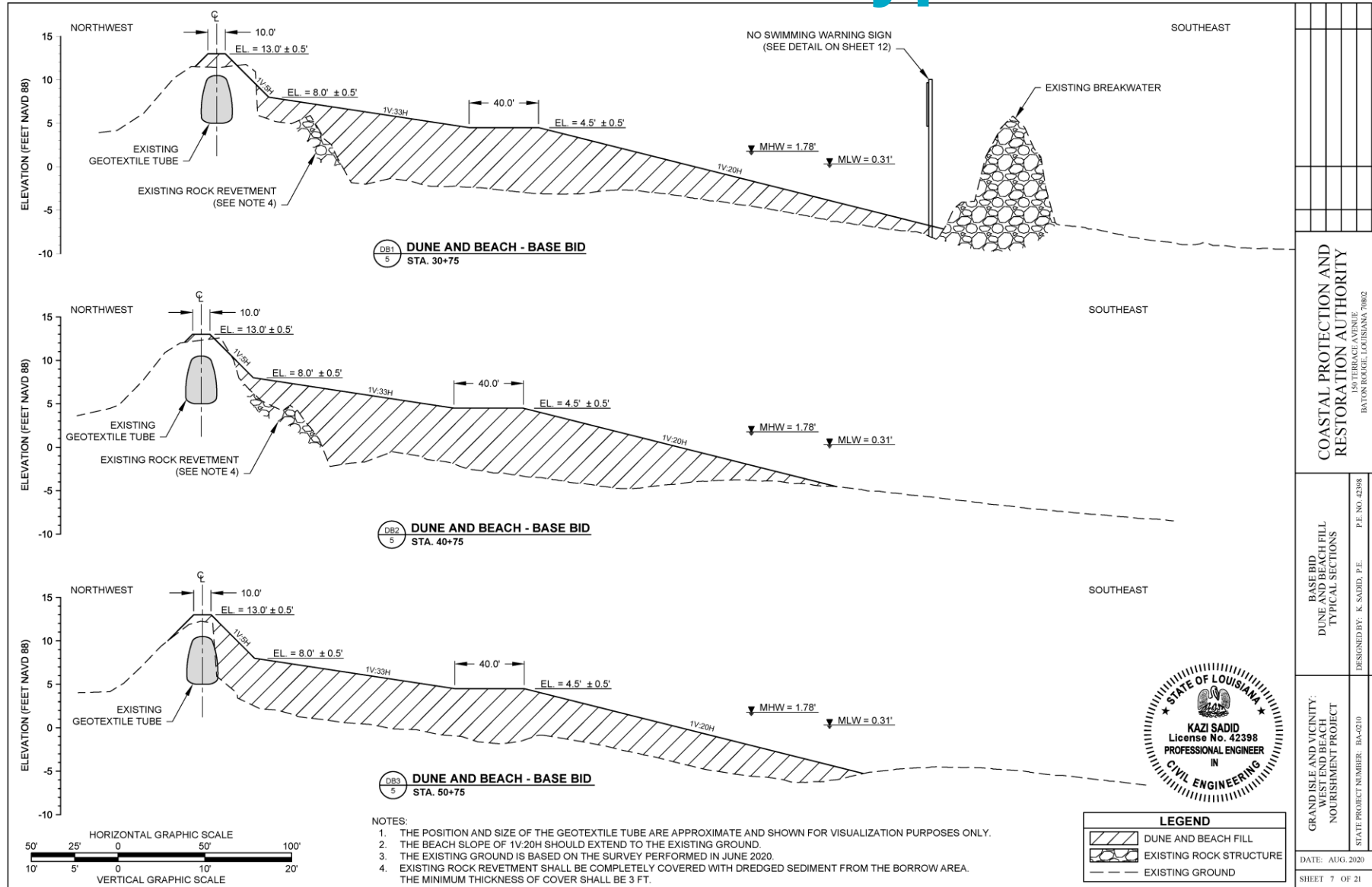

Sta. 10+82 – 28+25  
-Some Dune Scraping  
-Minimal Beach  
-Rock Revetment Intact

Sta. 28+25 – 40+75  
-Major Dune Scraping  
-No Beach  
-Damaged Rock Revetment  
-No Geotextile Tube Exposed

Sta. 40+75 – 55+75  
-Major Dune Scraping  
-No Beach  
-Rock Revetment Ends  
-Geotextile Tube Exposed

Sta. 55+75 – 65+75  
-Some Dune Scraping  
-Some Geotextile Exposed  
-Beach Present

# Sheet 8 – Alternate Bid Typical Section

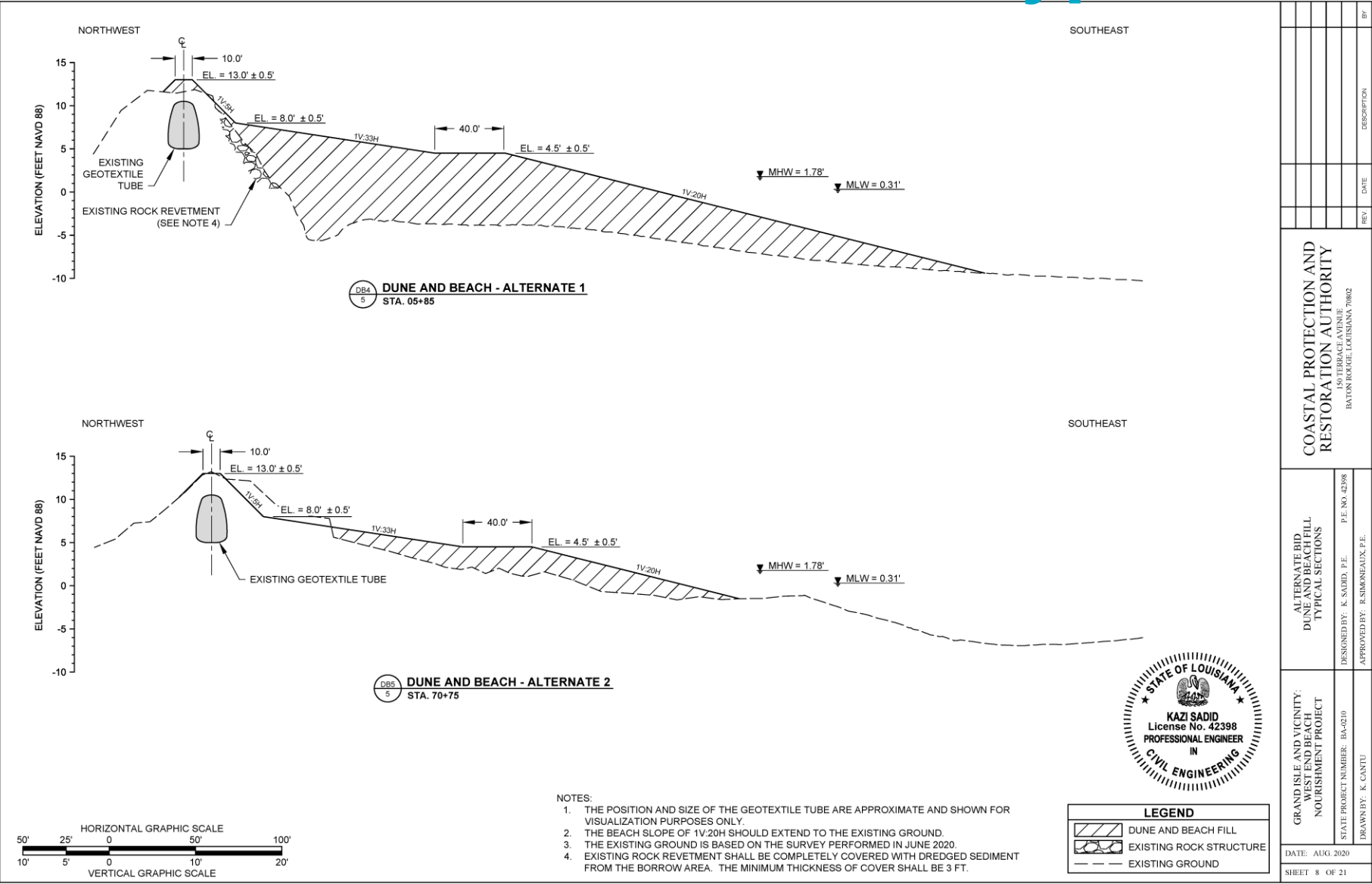

Sta. 02+88 – 10+82  
-Dune Scraping  
-Geotextile Tube Exposed  
-Minimal Beach

# Sheet 9 – Borrow Area Typical Section

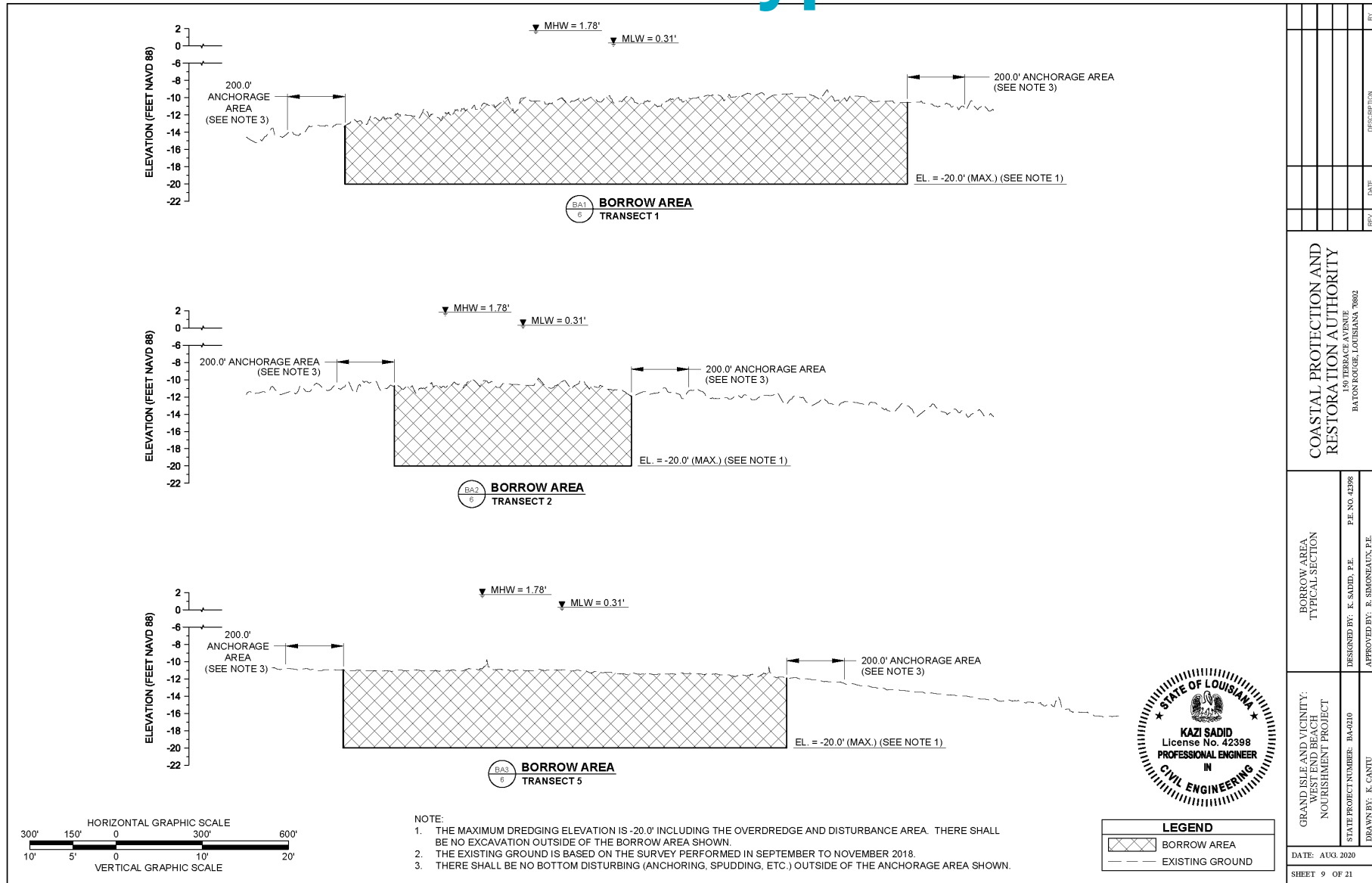

# Sheet 12 – Emergency Vehicle Crossing

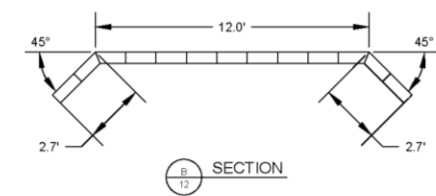
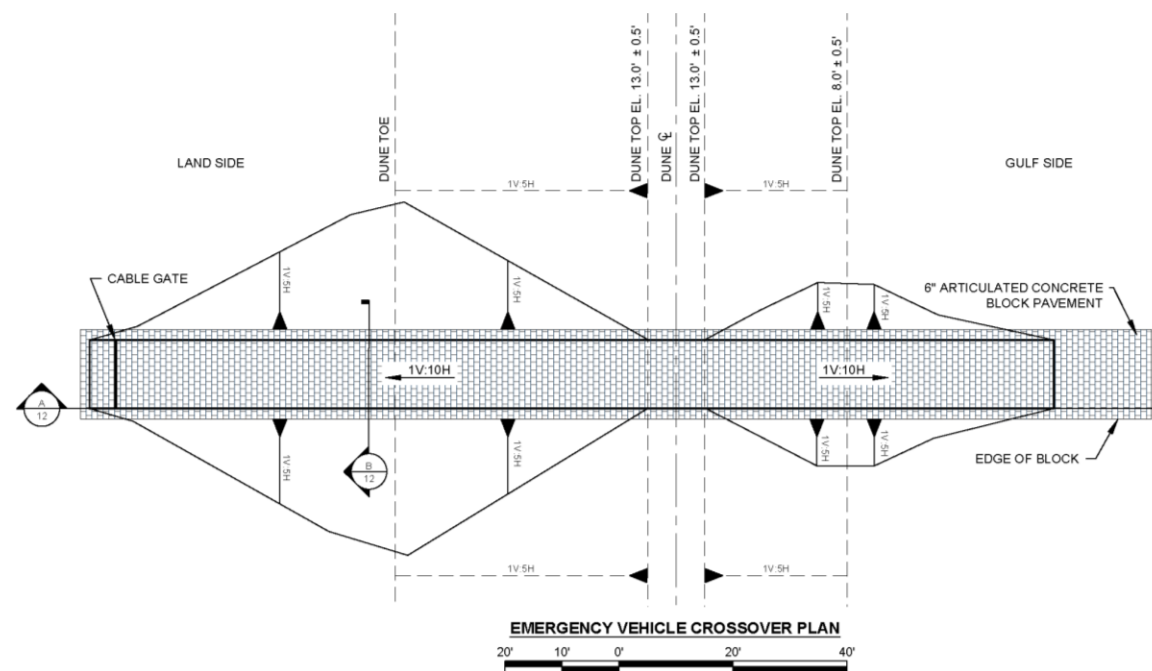

ARTICULATED CONCRETE BLOCK SPECIFICATIONS				
BLOCK NUMBER	WEIGHTS		UNIT COVERAGE SQ. FT.	OPEN AREA %
	UNIT WEIGHT LBS	SYSTEM WEIGHT LBS. PER SQ. FT.		
H-600-OC	45 - 53	45 - 53	1.0	25

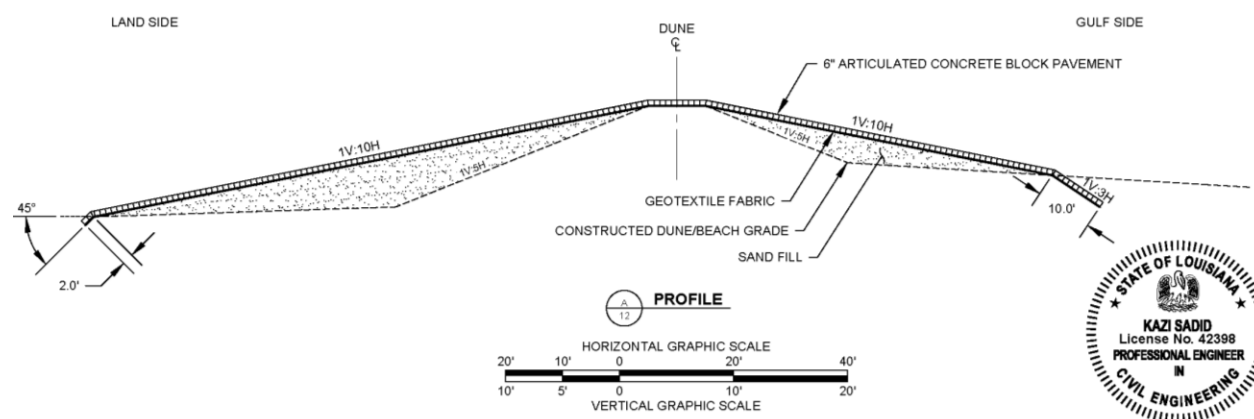
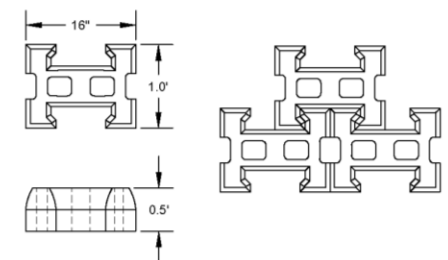

- ARTICULATED CONCRETE BLOCK DETAIL**  
NOT TO SCALE
- TECHNICAL SPECIFICATIONS:**
- SHORELOC UNITS ARE MANUFACTURED IN ACCORDANCE WITH ASTM C90 AND THE FOLLOWING CRITERIA.
    - CONCRETE UNIT WEIGHT 13-150 LBS/CF
    - MINIMUM COMPRESSIVE STRENGTH - 4,000 PSI
    - MAXIMUM ABSORPTION - 7%
    - DIMENSIONAL TOLERANCE ± 1/8"
- NOTES:**
- SHEET 5 SHOWS LOCATIONS OF EMERGENCY VEHICLE CROSSOVERS.
  - DETAIL SHOWN REPRESENTS RIGHT HAND ORIENTATION.
  - SLOPE ON LAND SIDE RAMP WILL BE VARIED AS NECESSARY TO STAY WITHIN EXISTING ROW AS DETERMINED BY ACTUAL FIELD CONDITIONS.



Oliver Lane EV Crossing





# Sheet 13 – Pedestrian Crossing

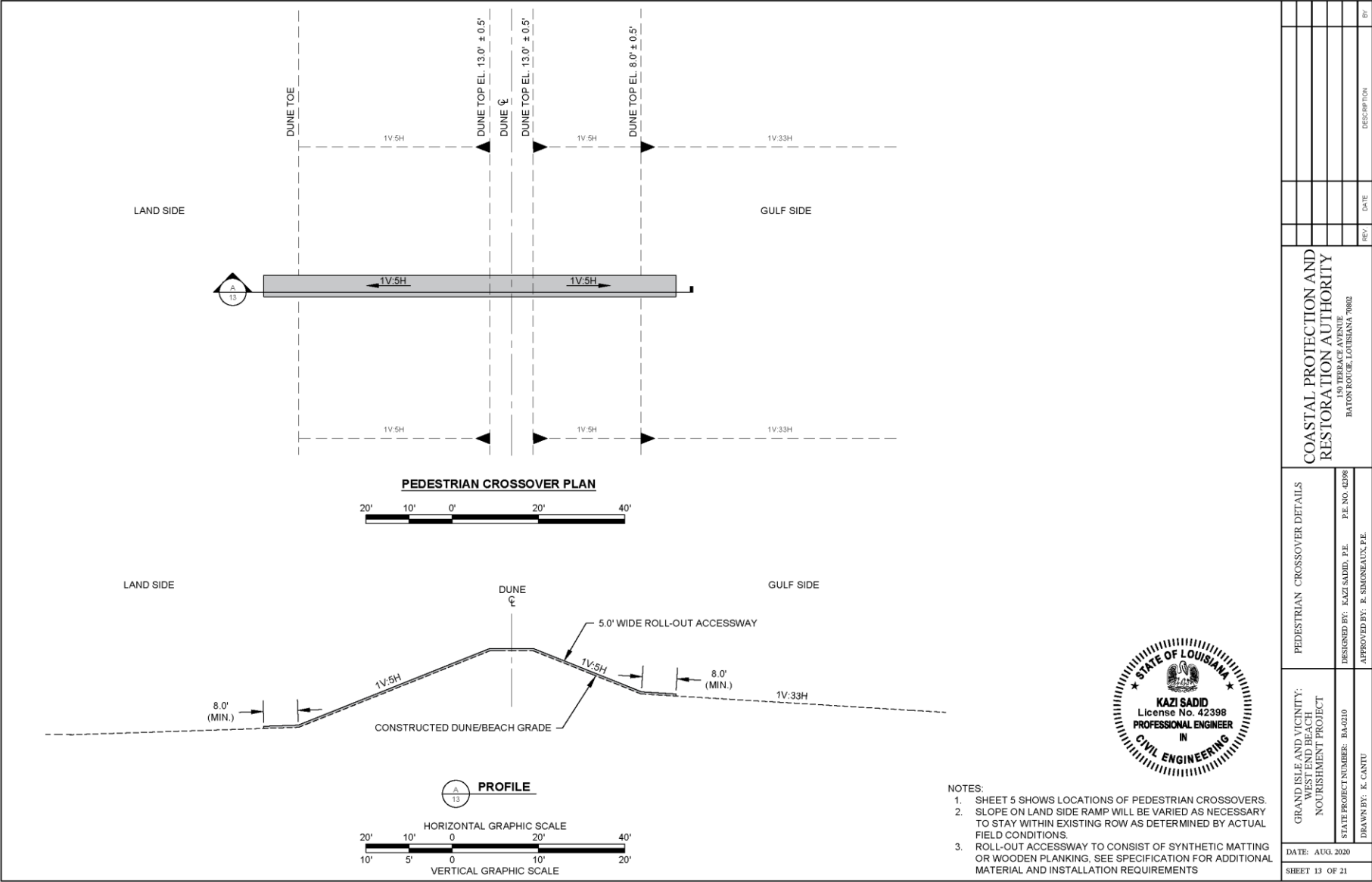

# Sheet 15 – Construction Survey Layout

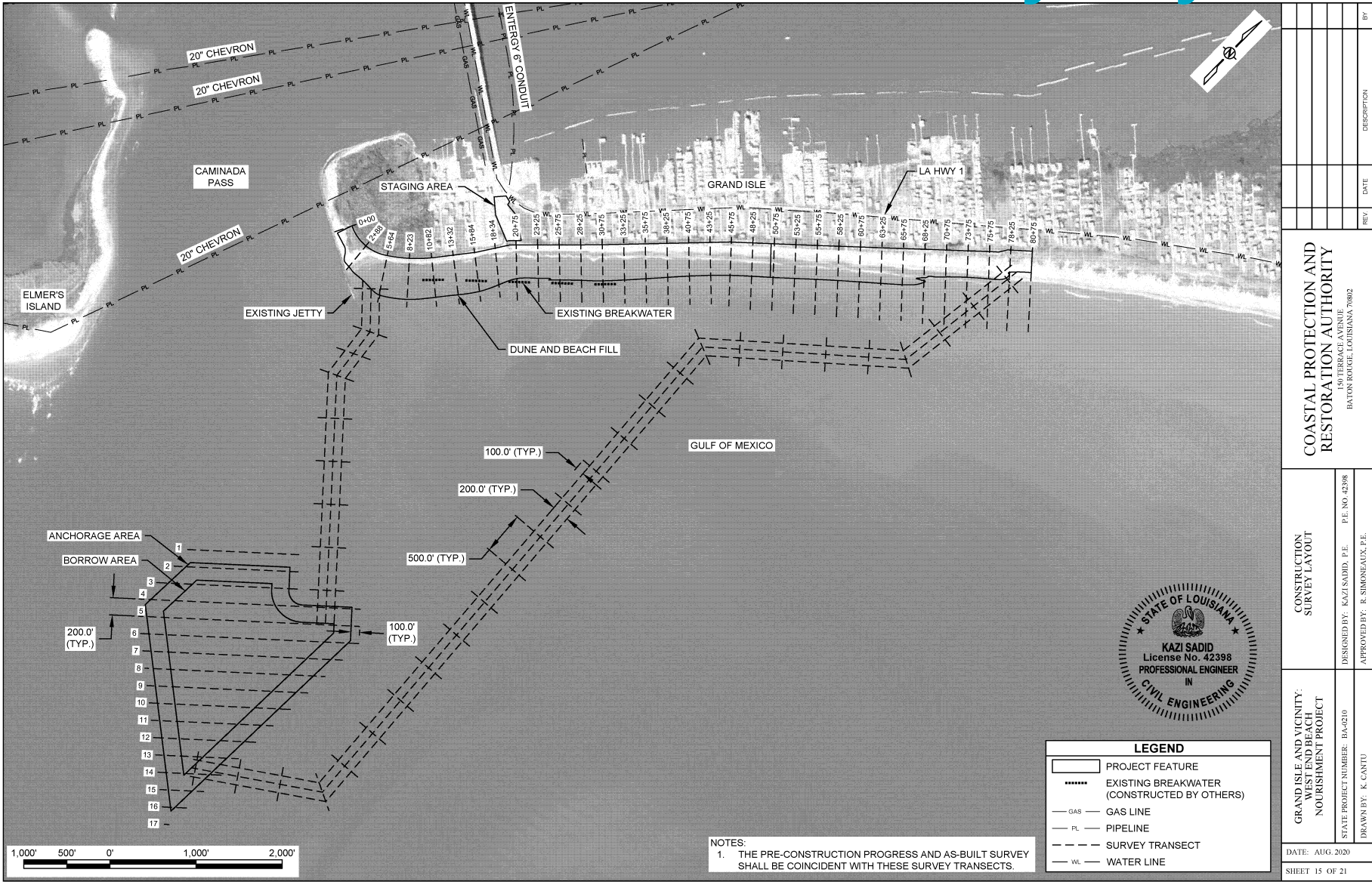

# Overview of Specifications



# Special Provisions

- SP-9 Contract Time: Total 110 consecutive calendar days from the NTP for Base Bid
  - Additional 14 days for Alternate No. 1 (If Awarded), and
  - Additional 7 days for Alternate No. 2 (If Awarded)
- SP-10 Failure to Complete on Time: Liquidated Damages \$5,000/day
- SP-11 Commencement and Completion Incentive: One-time payment of \$50,000
  - *If the Dredging and Beach Nourishment initiated within 45 days of the NTP, AND substantially completes the Work prior to the expiration of the Contract Time*
- SP-16 Permit: Emergency Authorization from the State included in Appendix E
  - Approval from USACE will be provided before the NTP is issued



# Special Provisions – Protection of Work (SP-13) and Misplaced Materials (SP-19)

- The Project Site is within close proximity to residential property, camps, and recreational areas; always protect the Project Site from public access
- The Project Site may be subject to water inundation during construction; protect the Work and Equipment from damages due to inflows
- No disposal/misplace of the dredged sediment, slurry, equipment or other materials outside of the authorized work zone
  - Misplaced Materials shall be removed at the Contractor's expense, and
  - Contractor will be responsible for restoring unauthorized disposal areas to pre-construction conditions

# Technical Specifications

- TS-110 EQUIPMENT ACCESS CORRIDOR (EAC)
  - Land-based access to the Beach is allowed at Mary Street and Oliver Lane only
  - The Beach can be accessed from the Gulf via the EAC shown on the Plan
  - Contractor may propose for other EAC in the Work Plan
  - All construction Equipment must be located within the Authorized EAC

## STAGING AREA

- The contractor may use the existing beach (within the Project Site) to stage the construction equipment or may secure their own Staging Area
- The state has not been able to obtain permission for a Staging Area

# Technical Specifications

- TS-401 HYDRAULIC DREDGING AND BEACH NOURISHMENT
  - 401.6 Deduction for Non-Conforming Work
    - No excavation below the permitted dredging depth
    - No excavation outside the permitted dredging limits (does not apply to the slopes of the dredge cut)
  - Payment will be deducted for sediment dredged outside of dredging limits shown in the Plan

# Technical Specifications

- TS-401 HYDRAULIC DREDGING AND BEACH NOURISHMENT
- 401.11 Sediment Characteristics
  - Predominantly fine sand (Approximately 95%)
  - $D_{50}$  of sand varies from 0.10 -0.15 mm
  - Average moisture content is 21%
  - Examine the geotechnical data in Appendix H

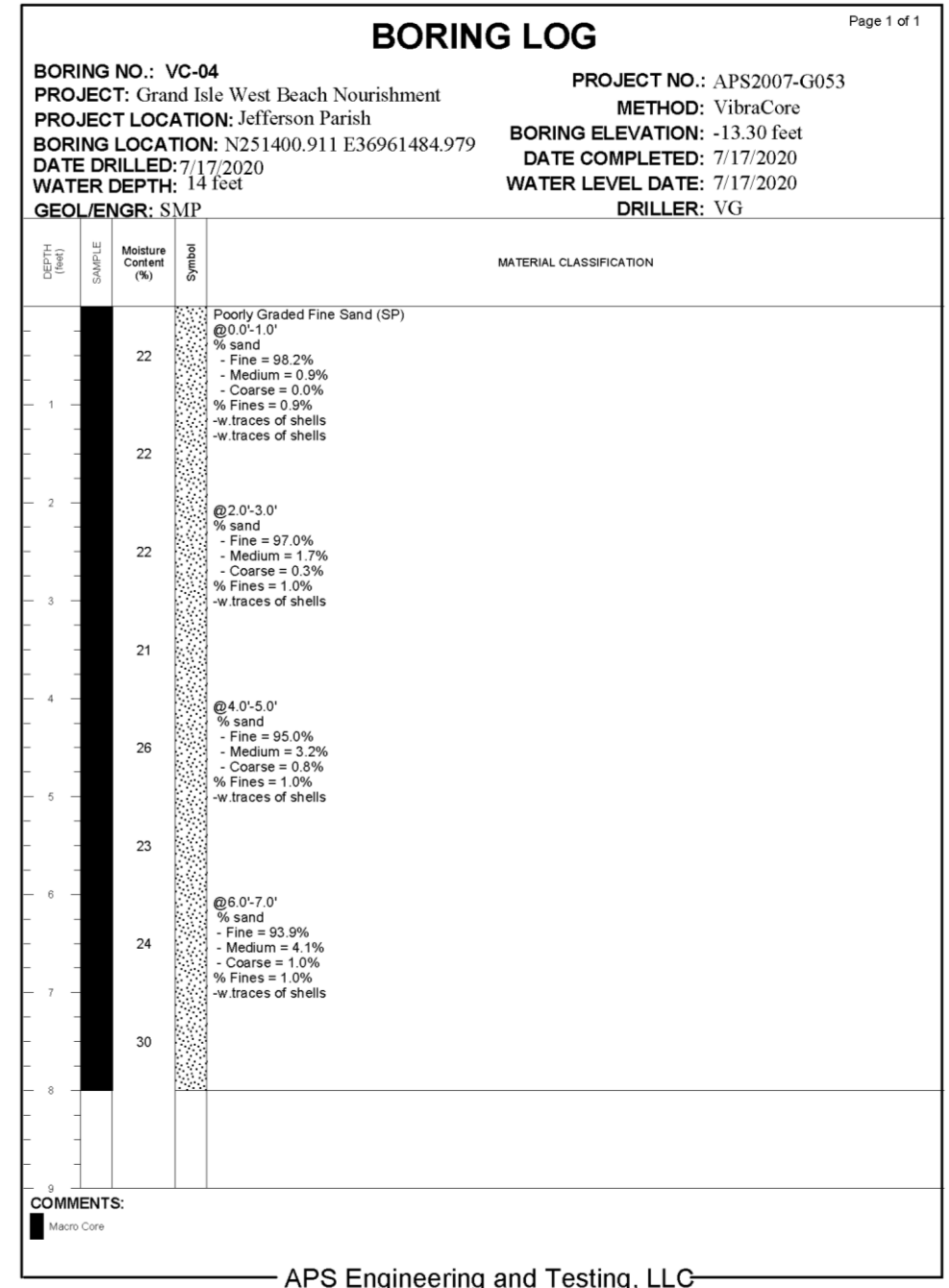



# Technical Specifications

- TS-401 HYDRAULIC DREDGING AND BEACH NOURISHMENT
- 401.12 Beach and Dune Fill
  - Establish a uniform beach and dune between adjacent survey transects
  - Existing Rock Revetment shall be covered with min. thickness 3 ft
  - Contractor may move around some Rocks to ensure the 3 ft cover
  - The **target Dune fill elevation = +13.0 ft NAVD88 with tolerance of  $\pm 0.5$  ft**
  - The **target Beach fill elevation = +8.0 ft NAVD88 with tolerance of  $\pm 0.5$  ft**
  - The **target Berm fill elevation = +4.5 ft NAVD88 with tolerance of  $\pm 0.5$  ft**
  - No payment for sand placed above the tolerances - the Contractor to remove sediment placed above these tolerances at no expense

# Technical Specifications

- TS-401 HYDRAULIC DREDGING AND BEACH NOURISHMENT
- 401.14 Measurement and Payment
  - Payments shall be based on volume of sediment removed from the Borrow Area
  - Contractor may request payment for every 250,000 CY of excavation
  - Payment will be made upon acceptance of the corresponding Beach Nourishment Area

# Questions





## **ADDENDUM 02 TO BID DOCUMENTS**

**Grand Isle and Vicinity: West End Beach Nourishment Project**

**(BA-0210)**

### **APPENDIX B: NON-MANDATORY PRE-BID ATTENDANCE RECORD**

**Pre-Bid Meeting  
August 24, 2020**

#### **Attendance List**

Mike Nitska, HydroTerra, 337-315-2190

[Mike.Nitska@hydroterratec.com](mailto:Mike.Nitska@hydroterratec.com)

Arin Ricks, Weeks Marine

[aricks@weeksmarine.com](mailto:aricks@weeksmarine.com)

Amy Parker, Weeks Marine

[asparker@weeksmarine.com](mailto:asparker@weeksmarine.com)

Dylan Trim, Rigid Constructors, LLC, 337-577-2428

[dylan@rigidconstructors.com](mailto:dylan@rigidconstructors.com)

Ethan Antoine, Rigid Constructors, LLC, 337-516-8010

[ethan@rigidconstructors.com](mailto:ethan@rigidconstructors.com)

Ancil Taylor, Callan Marine, 504-259-1801

[ataylor@callanmarineltd.com](mailto:ataylor@callanmarineltd.com)

Thea Baker, Manson Construction, 904-510-4982

[TLinkfield@mansonconstruction.com](mailto:TLinkfield@mansonconstruction.com)

Joe Caldwell, 318-655-6313

[jcaldwell@crosbydredging.com](mailto:jcaldwell@crosbydredging.com)

Kristen Kelley, Manson Construction, 904-524-5673

[kkelley@mansonconstruction.com](mailto:kkelley@mansonconstruction.com),

Steve Auernhamer, Great Lakes Dredge & Dock Company, LLC, 630-561-5138

[SRAuernhamer@gldd.com](mailto:SRAuernhamer@gldd.com)

Thomas Simnick, Weeks Marine Inc., 985-875-2500

[tsimnick@weeksmarine.com](mailto:tsimnick@weeksmarine.com)