

## INDEX TO SHEETS

GRAND ISLE AND VICINITY:  
WEST END BEACH NOURISHMENT PROJECT  
PROJECT NO. BA-0210  
JEFFERSON PARISH



DATE: AUG 2020		<div>COASTAL PROTECTION AND RESTORATION AUTHORITY</div> <div>150 TERRACE AVENUE BATON ROUGE, LOUISIANA 70802</div>					
SHEET 1 OF 21							
GRAND ISLE AND VICINITY; WEST END BEACH NOURISHMENT PROJECT				TITLE SHEET			
STATE PROJECT NUMBER: BA-0210				DESIGNED BY: K. SADID, P.E.	P.E. NO. 42398		
DRAWN BY: K. CANTU				APPROVED BY: R. SIMONEAUX, P.E.			
		REV.	DATE	DESCRIPTION	BY		



GENERAL NOTES:

1.

THE CONTRACTOR SHALL NOT, AT ANY TIME, TREAD ON EXISTING VEGETATION UNLESS OTHERWISE DIRECTED BY THE ENGINEER.
2.

THE CONTRACTOR SHALL BE RESPONSIBLE FOR NAVIGATING WITHIN THE LIMITS OF THE PROJECT SITE. THE ENGINEER OR HIS REPRESENTATIVE SHALL MONITOR THE CONTRACTOR'S LOCATION DURING CONSTRUCTION.
3.

PLANS AND SPECIFICATIONS ARE COMPLEMENTARY; WHAT IS REQUIRED BY ONE IS BINDING AS IF REQUIRED BY ALL. CLARIFICATIONS AND INTERPRETATIONS OF, OR NOTIFICATIONS OF MINOR VARIATIONS AND DEVIATIONS IN THE CONTRACT DOCUMENTS, WILL BE ISSUED BY THE ENGINEER.
4.

ANY DAMAGE TO EXISTING U.S. COAST GUARD NAVIGATION AIDS OR PRIVATE NAVIGATION AIDS SHALL BE REPAIRED BY THE CONTRACTOR TO U.S. COAST GUARD STANDARDS AT THE EXPENSE OF THE CONTRACTOR.
5.

THE BEACH NOURISHMENT AREA AND BORROW AREA MAY BE REVISED BY THE ENGINEER THROUGHOUT THE WORK TO REFLECT CHANGES IN FIELD CONDITIONS.
6.

THE CONTRACTOR SHALL PERFORM A MAGNETOMETER SURVEY OF THE EQUIPMENT ACCESS CORRIDORS, BORROW AREA, AND BEACH NOURISHMENT AREA PRIOR TO EXCAVATION. DRAWINGS SHOWING THE TRACK LINES, ANY MAGNETOMETER HITS, COORDINATES, AMPLITUDE, SIGNATURE TYPE, AND SIGNATURE WIDTH OF ALL MAGNETOMETER HITS SHALL BE SUBMITTED TO THE ENGINEER PRIOR TO EXCAVATION.
7.

PIPELINES AND UTILITIES SHOWN ON THE PLANS ARE APPROXIMATE. THE CONTRACTOR SHALL NOT EXCAVATE WITHIN 500' OF EXISTING PIPELINE NEAR THE BORROW AREA OR WITHIN 75' OF EXISTING PIPELINE AND UTILITY NEAR THE BEACH NOURISHMENT AREA AND THE EQUIPMENT ACCESS CORRIDOR.
8.

THE CONTRACTOR IS RESPONSIBLE FOR CONTAINING ALL HYDRAULICALLY DREDGED MATERIAL WITHIN THE BOUNDARIES OF THE BEACH NOURISHMENT AREA.

NOTIFICATIONS:

1.

THE CONTRACTOR SHALL ADHERE TO THE MOST CURRENT PUBLICATIONS OF "RECOMMENDED BEST PRACTICES GUIDE FOR SAFE DREDGING NEAR UNDERWATER GAS & HAZARDOUS LIQUID PIPELINES", WWW.CDMCS.ORG, AND "WORKING SAFELY NEAR UNDERWATER PIPELINES", WWW.CAMOGROUP.ORG .
2.

THE CONTRACTOR SHALL BE RESPONSIBLE FOR NOTIFYING THE FOLLOWING PIPELINE AND UTILITY OPERATORS AT LEAST FIVE (5) WORKING DAYS IN ADVANCE OF THE WORK. PIPELINES LOCATED WITHIN 150' OF THE WORK SHALL BE MARKED BY THE CONTRACTOR. THE CONTRACTOR SHALL MAINTAIN BUOYS DURING CONSTRUCTION AND HAVE ADEQUATE NAVIGATIONAL EQUIPMENT ON THE DREDGE TO AVOID DREDGING IN RESTRICTED AREAS. THE CONTRACTOR SHALL CONTACT LOUISIANA ONE CALL AT 1-800-272-3020 5 DAYS PRIOR TO ANY EXCAVATION AND/OR DREDGING TO LOCATE ALL PIPELINES OR UTILITIES.

CHEVRON (NORTH)  
CONTACT: TROY BROWN  
PHONE: (713) 289-2400

CHEVRON (MIDDLE)  
CONTACT: GARRETT PARKER  
PHONE: (832) 854-4596

ENTERGY  
CONTACT: ERIC VICKERS  
PHONE: (504) 915-0415

DESIGN NOTES:

1.

ALL ELEVATIONS ARE GIVEN IN THE NORTH AMERICAN VERTICAL DATUM OF 1988 (NAVD 88) U.S. SURVEY FEET. ALL HORIZONTAL COORDINATES ARE GIVEN IN THE NORTH AMERICAN DATUM OF 1983 (NAD 83, LOUISIANA STATE PLANE SOUTH ZONE U.S. FEET). ALL ELEVATIONS ARE BASED ON THE FOLLOWING MONUMENT DATA USING THE LATEST GEOID:

SURVEY MONUMENT	GEOID	ELEVATION	NORTHING	EASTING
N 221	12B	4.84'	258,567.60	3,693,447.85
Q388	12B	2.91'	266,522.31	3,704,034.66
2.

THE BEACH NOURISHMENT AREA SURVEY DATA ARE BASED ON SURVEYS PERFORMED BY HYDROTERRA TECHNOLOGIES, LLC IN JUNE 2020 FOR CPRA. THE BORROW AREA AND THE EQUIPMENT ACCESS CORRIDOR SURVEY DATA ARE BASED ON SURVEYS PERFORMED FROM SEPTEMBER TO NOVEMBER 2019 BY THE USACE. BACKGROUND IMAGERY WAS TAKEN IN YEAR, 2018.
3.

DATA FROM STATION USGS 073802516 BARATARIA PASS AT GRAND ISLE, LA WAS USED TO CALCULATE THE MHW AND MLW. ELEVATIONS ARE REFERENCED TO NAVD 88, US FEET, GEOID 12B. MHW = 1.78' AND MLW = 0.31' WITHIN PROJECT AREA.
4.

GEOTECHNICAL SUBSURFACE INVESTIGATIONS WERE PERFORMED BY EUSTIS ENGINEERING IN APRIL 2019 AND BY APS IN JULY 2020. THE SOIL BORING AND VIBRACORES LOCATIONS ARE SHOWN THE PLANS. THE GEOTECHNICAL SUBSURFACE INVESTIGATION REPORT IS PROVIDED IN THE SPECIFICATION APPENDICES.

SUMMARY OF ESTIMATED QUANTITIES

BASE BID

ITEM No.	DESCRIPTION	UNIT	ESTIMATED QUANTITY <sup>1</sup>
1	MOBILIZATION AND DEMOBILIZATION (TS-100)	LS	1
2	CONSTRUCTION SURVEYS: STA. 10+82 - STA. 65+75 (TS-200)	LS	1
3	HYDRAULIC DREDGING AND BEACH NOURISHMENT: STA. 10+82 - STA. 65+75 (TS-401) <sup>2</sup>	CY	458,000
4	SAND FENCING: STA. 10+82 - STA. 65+75 (TS-950)	LF	5,800
5	PEDESTRIAN AND VEHICULAR CROSSING: MARY STREET, OLIVER LANE, AND JACKSON LANE (TS-850)	LS	1

ALTERNATE 1 BID

ITEM No.	DESCRIPTION	UNIT	ESTIMATED QUANTITY <sup>1</sup>
6	CONSTRUCTION SURVEYS: STA. 0+00 - STA. 10+82 (TS-200)	LS	1
7	HYDRAULIC DREDGING AND BEACH NOURISHMENT: STA. 0+00 - STA. 10+82 (TS-401) <sup>2</sup>	CY	109,000
8	SAND FENCING: STA. 0+00 - STA. 10+82 (TS-950)	LF	1,200

ALTERNATE 2 BID

ITEM No.	DESCRIPTION	UNIT	ESTIMATED QUANTITY <sup>1</sup>
9	CONSTRUCTION SURVEYS: STA. 65+75 - STA. 80+75 (TS-200)	LS	1
10	HYDRAULIC DREDGING AND BEACH NOURISHMENT: STA. 65+75 - STA. 80+75 (TS-401) <sup>2</sup>	CY	37,000
11	SAND FENCING: STA. 65+75 - STA. 80+75 (TS-950)	LF	1,600
12	PEDESTRIAN AND VEHICULAR CROSSING: BOUDREAUX LANE (TS-850)	LS	1

1.

THE QUANTITIES SHOWN WERE CALCULATED BASED ON THE SPECIFIED TIME PERIOD. THE OWNER RESERVES THE RIGHT TO ADJUST QUANTITIES 25% HIGHER OR LOWER WITHOUT ADJUSTMENT OF THE UNIT PRICE.
2.

QUANTITY IS BASED ON THE BORROW AREA CUT VOLUMES. PAYMENT QUANTITY WILL BE BASED ON PROGRESS SURVEYS OF THE BORROW AREA.

UNIT ABBREVIATIONS:

CY CUBIC YARD  
EL ELEVATION  
FT FOOT  
LF LINEAR FOOT  
LS LUMP SUM  
NTS NOT TO SCALE  
SF SQUARE FOOT



COASTAL PROTECTION AND RESTORATION AUTHORITY  
150 TERRACE AVENUE  
BATON ROUGE, LOUISIANA 70802

GENERAL NOTES

GRAND ISLE AND VICINITY:  
WEST END BEACH  
NOURISHMENT PROJECT



WEST DREDGE PIPELINE CORRIDOR

PT.	NORTHING	EASTING
A1	256,555.81	3,693,457.35
A2	256,194.42	3,693,800.89
A3	255,564.55	3,693,885.68
A4	253,433.90	3,695,828.27

EAST DREDGE PIPELINE CORRIDOR

PT.	NORTHING	EASTING
A5	261,997.97	3,698,620.06
A6	260,366.74	3,698,426.63
A7	258,798.90	3,696,653.44
A8	252,022.40	3,697,190.40
A9	251,147.92	3,695,916.45

SIGNIFICANT ANOMALY

	NORTHING	EASTING
A	254,060.92	3,694,861.71
B	254,083.15	3,694,255.14
C	253,517.62	3,695,378.46

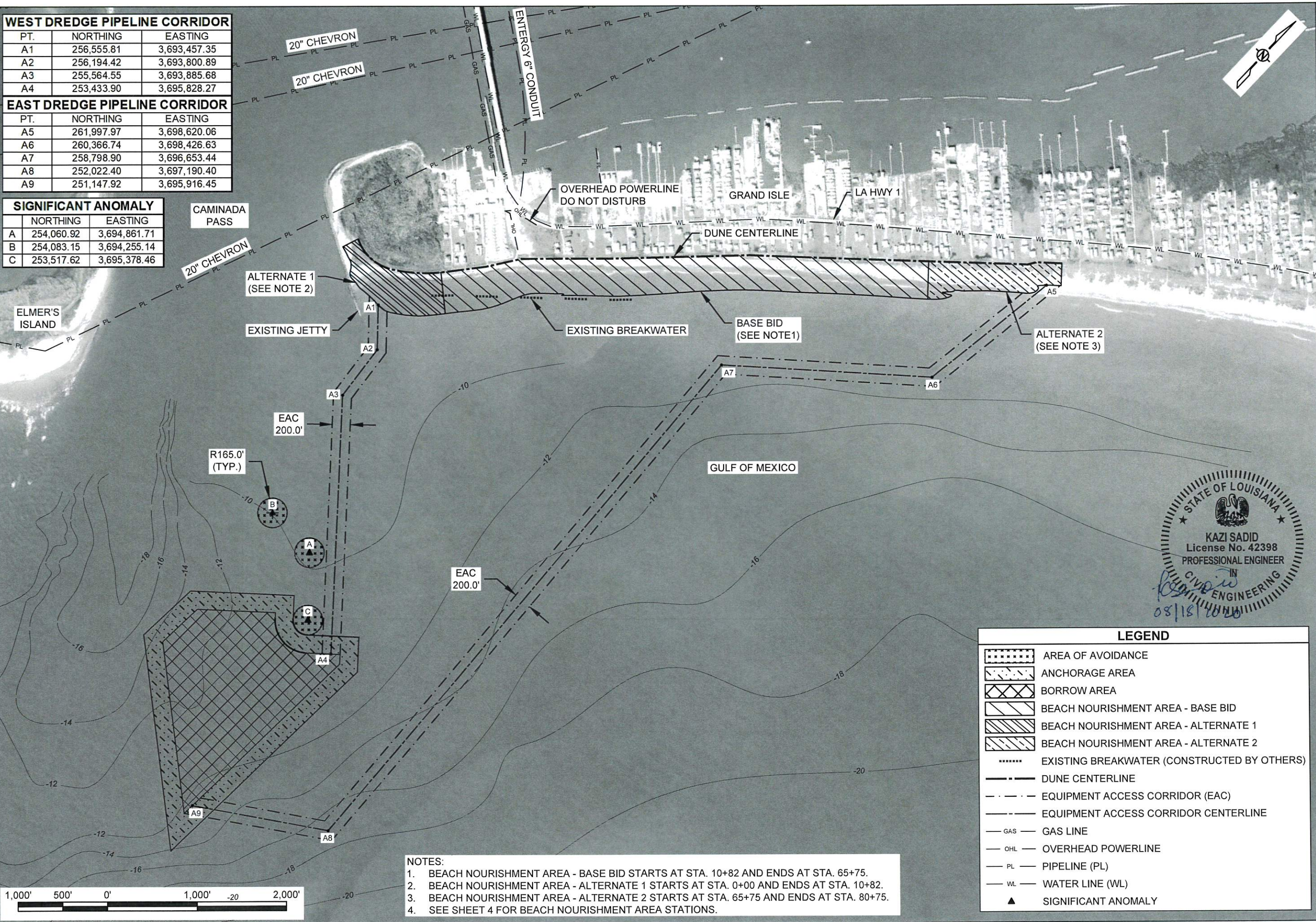

NOTES:

1. BEACH NOURISHMENT AREA - BASE BID STARTS AT STA. 10+82 AND ENDS AT STA. 65+75.
2. BEACH NOURISHMENT AREA - ALTERNATE 1 STARTS AT STA. 0+00 AND ENDS AT STA. 10+82.
3. BEACH NOURISHMENT AREA - ALTERNATE 2 STARTS AT STA. 65+75 AND ENDS AT STA. 80+75.
4. SEE SHEET 4 FOR BEACH NOURISHMENT AREA STATIONS.

LEGEND

	AREA OF AVOIDANCE
	ANCHORAGE AREA
	BORROW AREA
	BEACH NOURISHMENT AREA - BASE BID
	BEACH NOURISHMENT AREA - ALTERNATE 1
	BEACH NOURISHMENT AREA - ALTERNATE 2
	EXISTING BREAKWATER (CONSTRUCTED BY OTHERS)
	DUNE CENTERLINE
	EQUIPMENT ACCESS CORRIDOR (EAC)
	EQUIPMENT ACCESS CORRIDOR CENTERLINE
	GAS LINE
	OVERHEAD POWERLINE
	PIPELINE (PL)
	WATER LINE (WL)
	SIGNIFICANT ANOMALY

COASTAL PROTECTION AND  
RESTORATION AUTHORITY  
150 TERRACE AVENUE  
BATON ROUGE, LOUISIANA 70802

PROJECT LAYOUT

GRAND ISLE AND VICINITY;  
WEST END BEACH  
NOURISHMENT PROJECT

DATE: AUG. 2020

SHEET 3 OF 21

DESIGNED BY: KAZI SADID, P.E. P.E. NO. 42398  
APPROVED BY: R. SIMONEAUX, P.E.

STATE PROJECT NUMBER: BA-0210  
DRAWN BY: K. CANTU





SOIL BORINGS		
ID	NORTHING	EASTING
C-1	255,373.62	3,693,920.56
C-2	253,663.86	3,695,061.51
C-3	251,433.74	3,696,143.19
VIBRACORE		
ID	NORTHING	EASTING
VC-01	253,121.74	3,695,780.97
VC-02	251,915.62	3,696,676.71
VC-03	252,341.89	3,694,536.34
VC-04	251,167.51	3,695,861.14

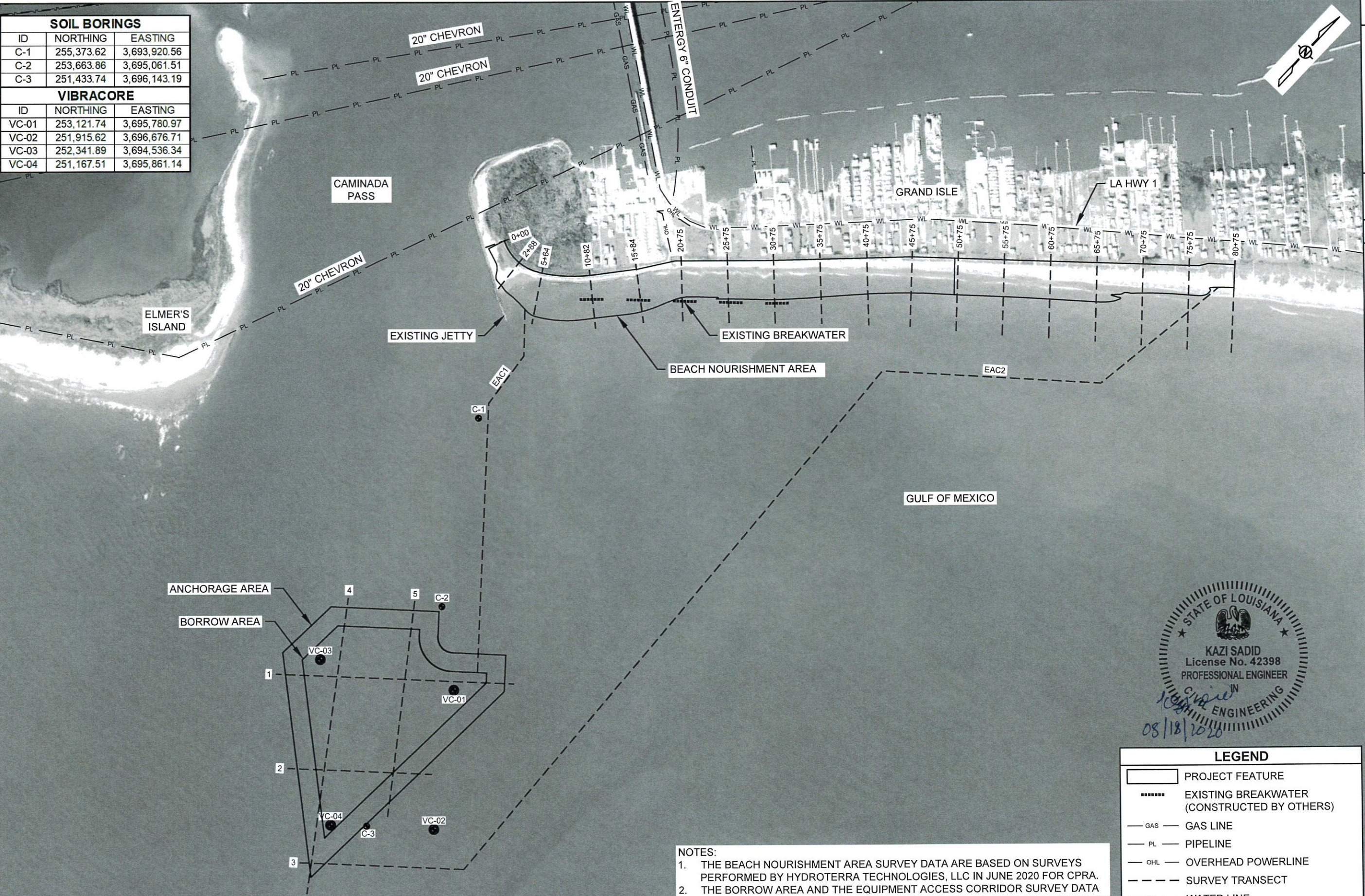

- NOTES:
1. THE BEACH NOURISHMENT AREA SURVEY DATA ARE BASED ON SURVEYS PERFORMED BY HYDROTERRA TECHNOLOGIES, LLC IN JUNE 2020 FOR CPRA.
  2. THE BORROW AREA AND THE EQUIPMENT ACCESS CORRIDOR SURVEY DATA ARE BASED ON SURVEYS PERFORMED FROM SEPTEMBER TO NOVEMBER 2019 BY THE USACE. BACKGROUND IMAGERY WAS TAKEN IN YEAR, 2018.
  3. GEOTECHNICAL SUBSURFACE INVESTIGATIONS WERE PERFORMED BY EUSTIS ENGINEERING IN APRIL 2019 AND BY APS IN JULY 2020.



LEGEND	
	PROJECT FEATURE
	EXISTING BREAKWATER (CONSTRUCTED BY OTHERS)
	GAS LINE
	PIPELINE
	OVERHEAD POWERLINE
	SURVEY TRANSECT
	WATER LINE
	SOIL BORING
	VIBRACORE

COASTAL PROTECTION AND RESTORATION AUTHORITY 150 TERRACE AVENUE BATON ROUGE, LOUISIANA 70802		REV.	DATE	DESCRIPTION	BY
DESIGN SURVEY LAYOUT		DESIGNED BY: KAZI SADID, P.E. P.E. 42398			
		APPROVED BY: R. SIMONEAUX, P.E.			
GRAND ISLE AND VICINITY: WEST END BEACH NOURISHMENT PROJECT		STATE PROJECT NUMBER: BA-0210			
		DRAWN BY: K. CANTU			
		DATE: AUG. 2020			
		SHEET 4 OF 21			



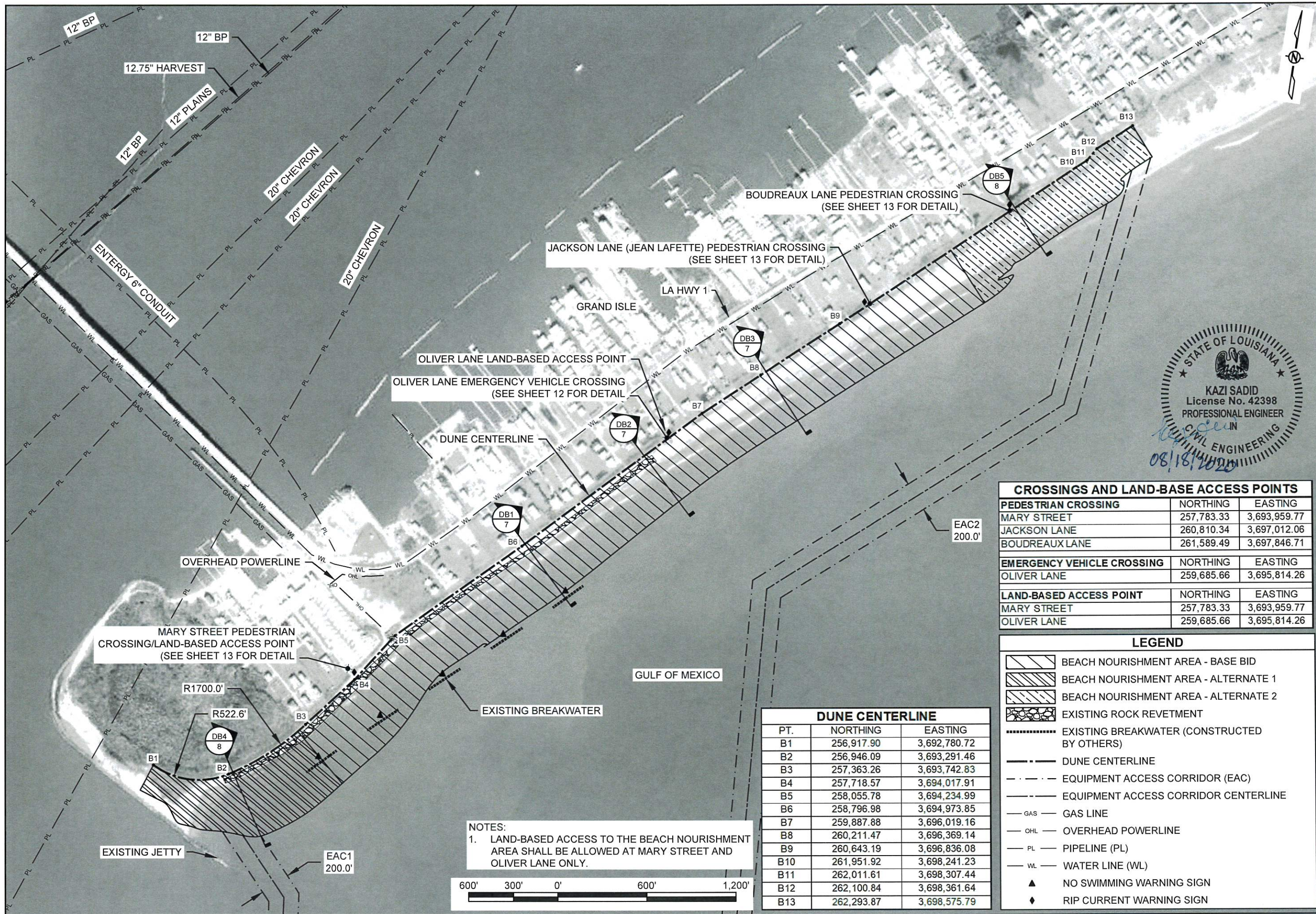

NOTES:  
1. LAND-BASED ACCESS TO THE BEACH NOURISHMENT AREA SHALL BE ALLOWED AT MARY STREET AND OLIVER LANE ONLY.



CROSSINGS AND LAND-BASE ACCESS POINTS		
PEDESTRIAN CROSSING	NORTHING	EASTING
MARY STREET	257,783.33	3,693,959.77
JACKSON LANE	260,810.34	3,697,012.06
BOUDREAUX LANE	261,589.49	3,697,846.71
EMERGENCY VEHICLE CROSSING	NORTHING	EASTING
OLIVER LANE	259,685.66	3,695,814.26
LAND-BASED ACCESS POINT	NORTHING	EASTING
MARY STREET	257,783.33	3,693,959.77
OLIVER LANE	259,685.66	3,695,814.26

LEGEND	
	BEACH NOURISHMENT AREA - BASE BID
	BEACH NOURISHMENT AREA - ALTERNATE 1
	BEACH NOURISHMENT AREA - ALTERNATE 2
	EXISTING ROCK REVETMENT
	EXISTING BREAKWATER (CONSTRUCTED BY OTHERS)
	DUNE CENTERLINE
	EQUIPMENT ACCESS CORRIDOR (EAC)
	EQUIPMENT ACCESS CORRIDOR CENTERLINE
	GAS LINE
	OVERHEAD POWERLINE
	PIPELINE (PL)
	WATER LINE (WL)
	NO SWIMMING WARNING SIGN
	RIP CURRENT WARNING SIGN



COASTAL PROTECTION AND RESTORATION AUTHORITY  
150 TERRACE AVENUE  
BATON ROUGE, LOUISIANA 70802

DESIGNED BY: KAZI SADID, P.E. P.E. NO. 42398  
APPROVED BY: R. SIMONEAUX, P.E.

DATE: AUG. 2020

DUNE AND BEACH PLAN VIEW

GRAND ISLE AND VICINITY:  
WEST END BEACH NOURISHMENT PROJECT

STATE PROJECT NUMBER: BA-0210  
DRAWN BY: K. CANTU

REV.	DATE	DESCRIPTION	BY

SHEET 5 OF 21



ESTIMATED QUANTITIES

AVAILABLE VOLUME (CY)	ACRES
769,198	55

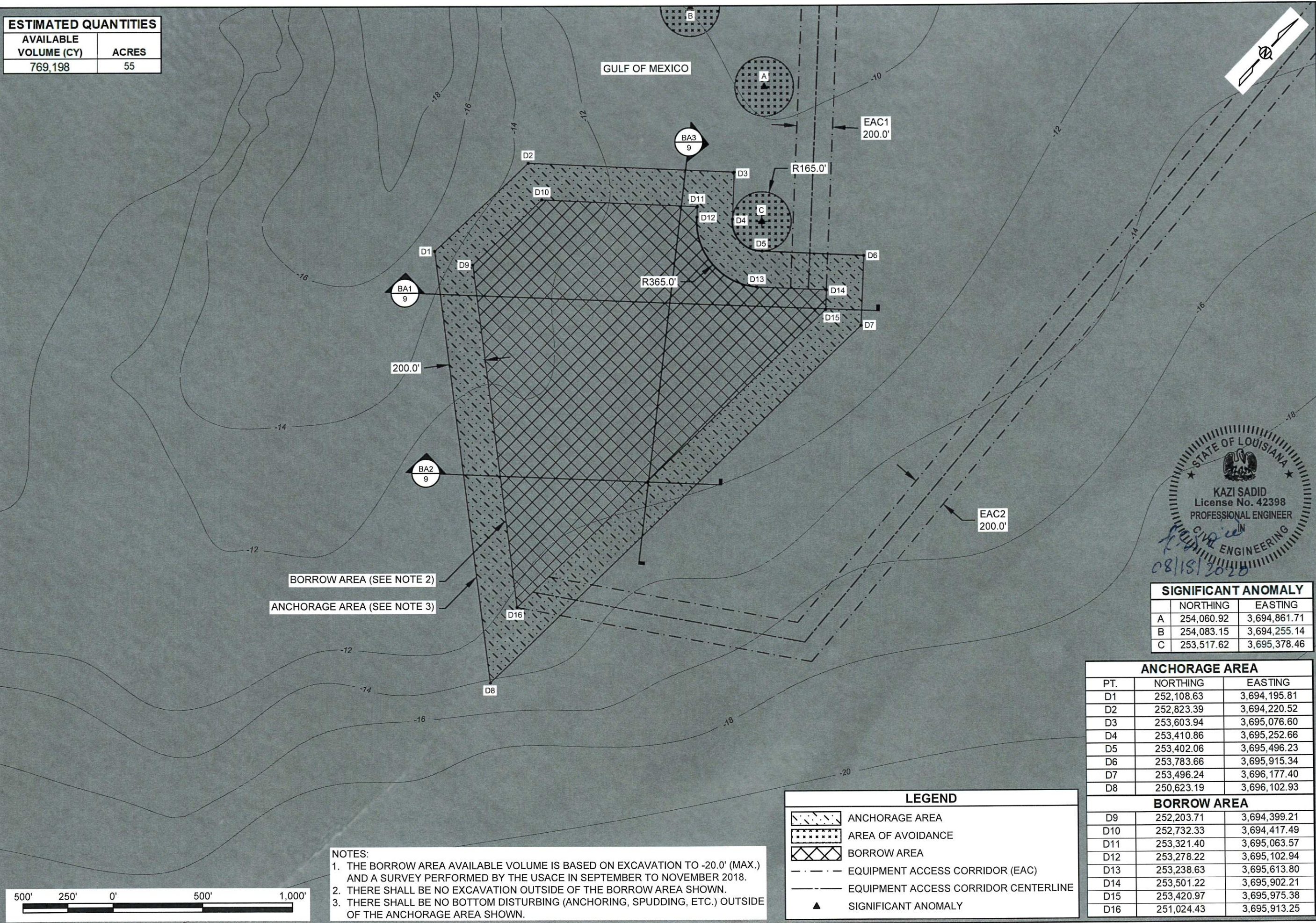

- NOTES:
1. THE BORROW AREA AVAILABLE VOLUME IS BASED ON EXCAVATION TO -20.0' (MAX.) AND A SURVEY PERFORMED BY THE USACE IN SEPTEMBER TO NOVEMBER 2018.
  2. THERE SHALL BE NO EXCAVATION OUTSIDE OF THE BORROW AREA SHOWN.
  3. THERE SHALL BE NO BOTTOM DISTURBING (ANCHORING, SPUDDING, ETC.) OUTSIDE OF THE ANCHORAGE AREA SHOWN.

LEGEND	
	ANCHORAGE AREA
	AREA OF AVOIDANCE
	BORROW AREA
	EQUIPMENT ACCESS CORRIDOR (EAC)
	EQUIPMENT ACCESS CORRIDOR CENTERLINE
	SIGNIFICANT ANOMALY

SIGNIFICANT ANOMALY

	NORTHING	EASTING
A	254,060.92	3,694,861.71
B	254,083.15	3,694,255.14
C	253,517.62	3,695,378.46

ANCHORAGE AREA

PT.	NORTHING	EASTING
D1	252,108.63	3,694,195.81
D2	252,823.39	3,694,220.52
D3	253,603.94	3,695,076.60
D4	253,410.86	3,695,252.66
D5	253,402.06	3,695,496.23
D6	253,783.66	3,695,915.34
D7	253,496.24	3,696,177.40
D8	250,623.19	3,696,102.93

BORROW AREA

	NORTHING	EASTING
D9	252,203.71	3,694,399.21
D10	252,732.33	3,694,417.49
D11	253,321.40	3,695,063.57
D12	253,278.22	3,695,102.94
D13	253,238.63	3,695,613.80
D14	253,501.22	3,695,902.21
D15	253,420.97	3,695,975.38
D16	251,024.43	3,695,913.25



COASTAL PROTECTION AND RESTORATION AUTHORITY

150 TERRACE AVENUE  
BATON ROUGE, LOUISIANA 70802

BORROW AREA  
PLAN VIEW

GRAND ISLE AND VICINITY:  
WEST END BEACH  
NOURISHMENT PROJECT

DATE: AUG 2020

SHEET 6 OF 21

DESIGNED BY: KAZI SADID, P.E. P.E. NO. 42398

APPROVED BY: R. SIMONEAUX, P.E.

DRAWN BY: K. CANTU

REV	DATE	DESCRIPTION	BY



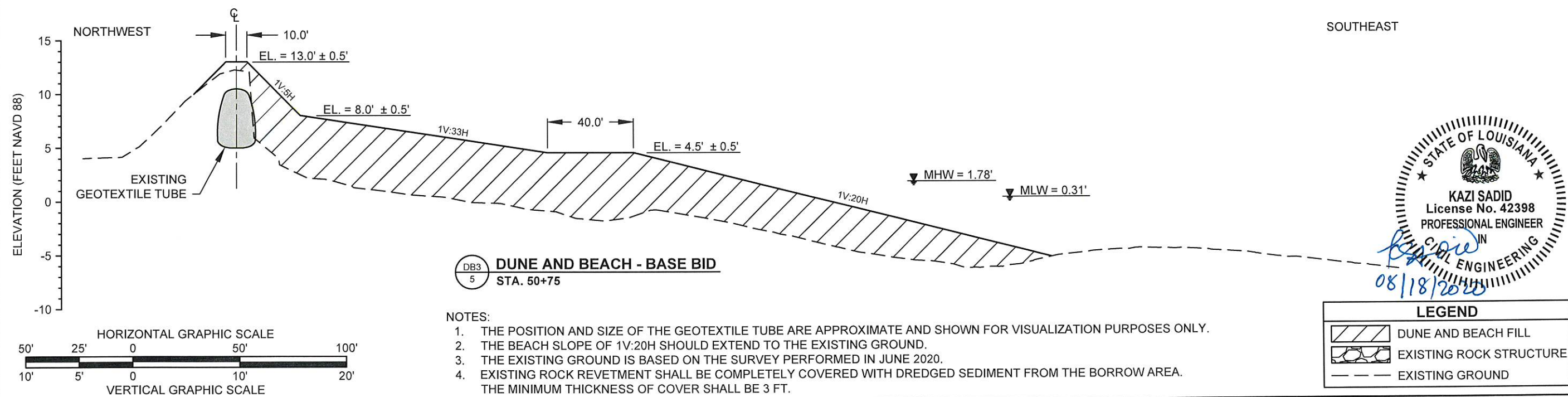
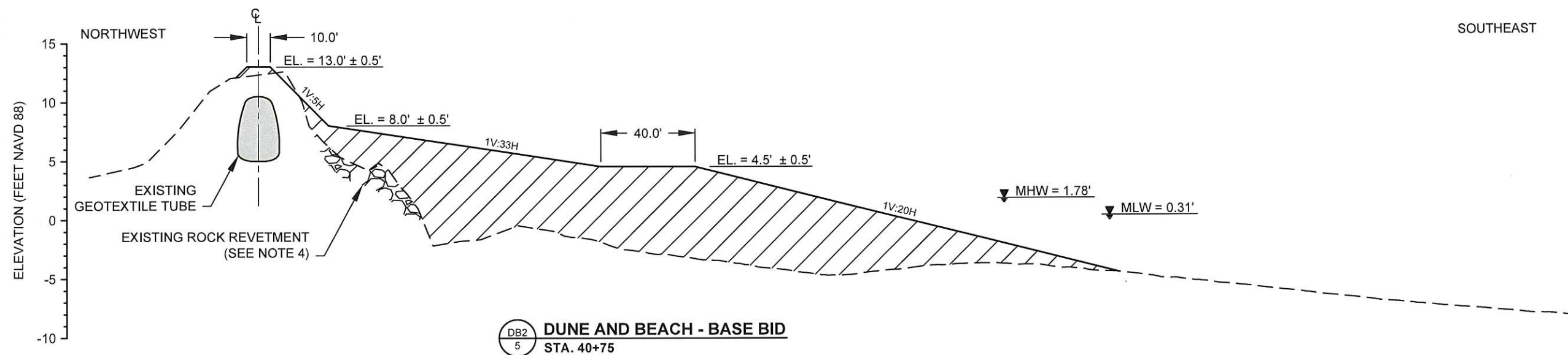
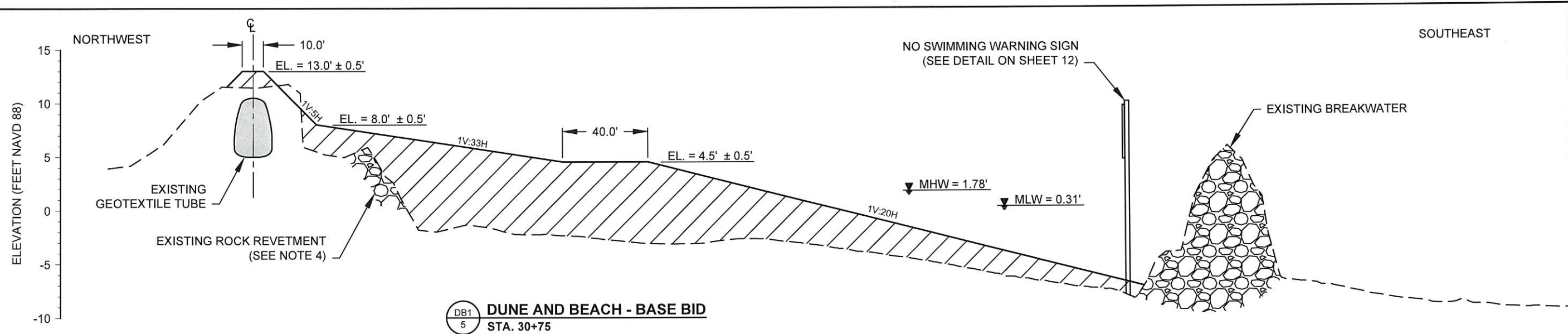



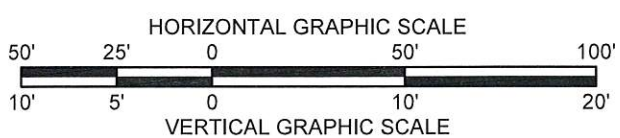
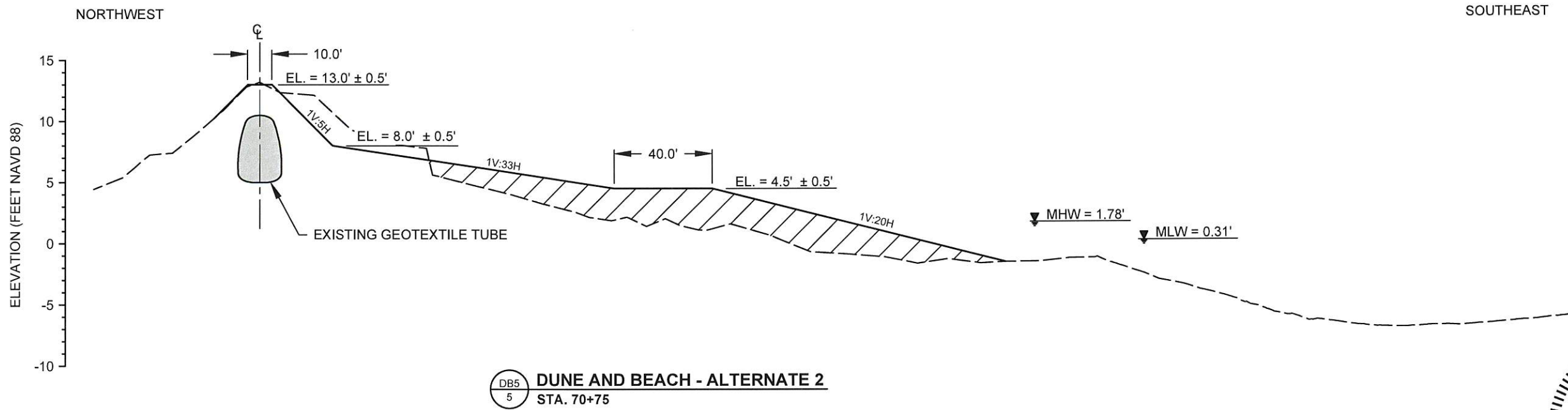
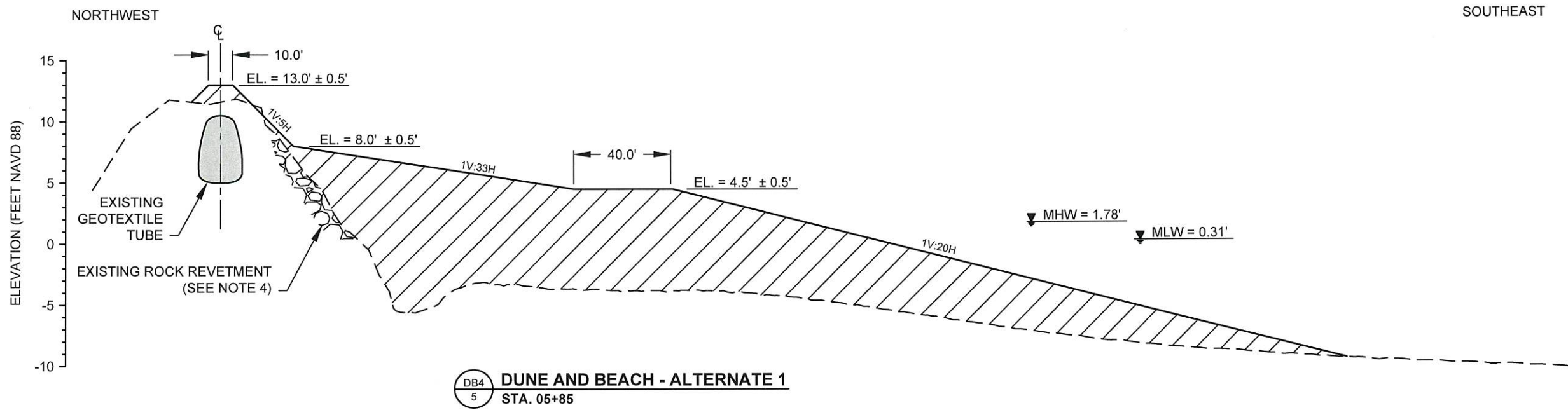

- NOTES:
1. THE POSITION AND SIZE OF THE GEOTEXTILE TUBE ARE APPROXIMATE AND SHOWN FOR VISUALIZATION PURPOSES ONLY.
  2. THE BEACH SLOPE OF 1V:20H SHOULD EXTEND TO THE EXISTING GROUND.
  3. THE EXISTING GROUND IS BASED ON THE SURVEY PERFORMED IN JUNE 2020.
  4. EXISTING ROCK REVETMENT SHALL BE COMPLETELY COVERED WITH DREDGED SEDIMENT FROM THE BORROW AREA. THE MINIMUM THICKNESS OF COVER SHALL BE 3 FT.

**LEGEND**

DUNE AND BEACH FILL  
 EXISTING GROUND  
 EXISTING ROCK STRUCTURE

STATE OF LOUISIANA  
 KAZI SADID  
 License No. 42398  
 PROFESSIONAL ENGINEER  
 08/18/2020

GRAND ISLE AND VICINITY: WEST END BEACH NOURISHMENT PROJECT		ALTERNATE BID DUNE AND BEACH FILL TYPICAL SECTIONS		COASTAL PROTECTION AND RESTORATION AUTHORITY 150 TERRACE AVENUE BATON ROUGE, LOUISIANA 70802							
STATE PROJECT NUMBER: BA-0210		DESIGNED BY: K. SADID, P.E.		P.E. NO. 42398							
DRAWN BY: K. CANTU		APPROVED BY: R. SIMONEAUX, P.E.				REV.	DATE	DESCRIPTION	BY		
DATE: AUG. 2020											
SHEET 8 OF 21											



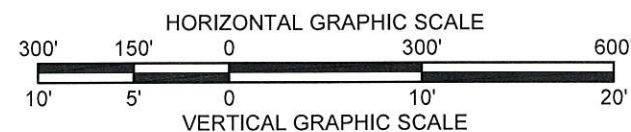
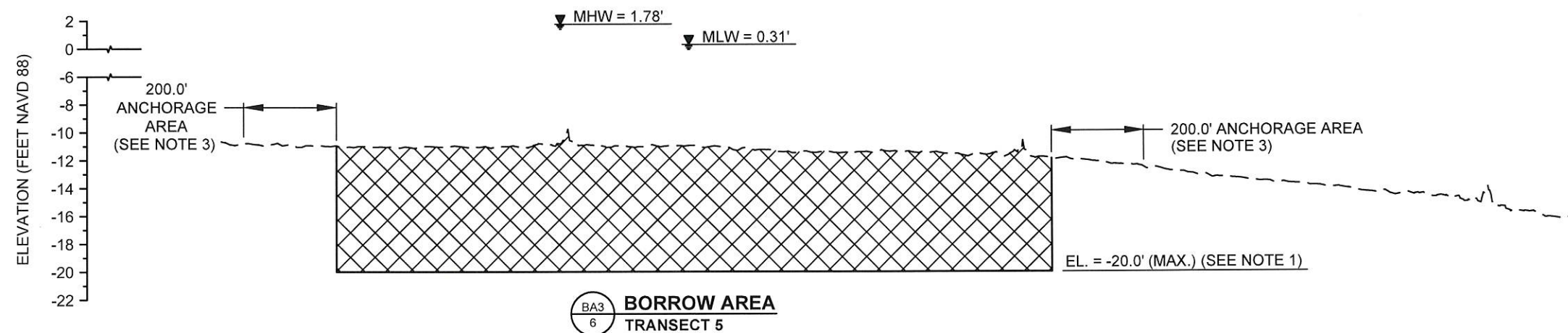
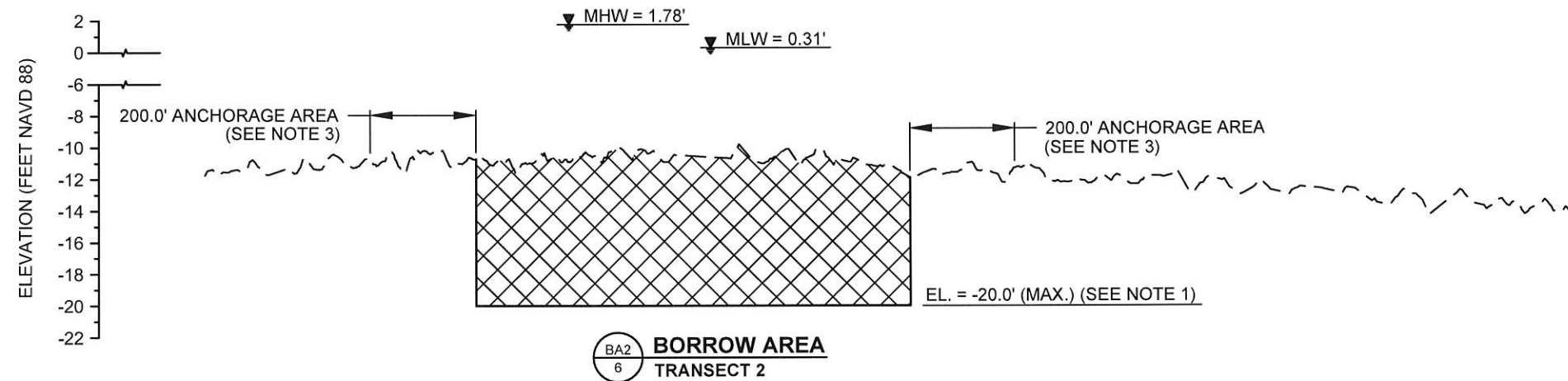
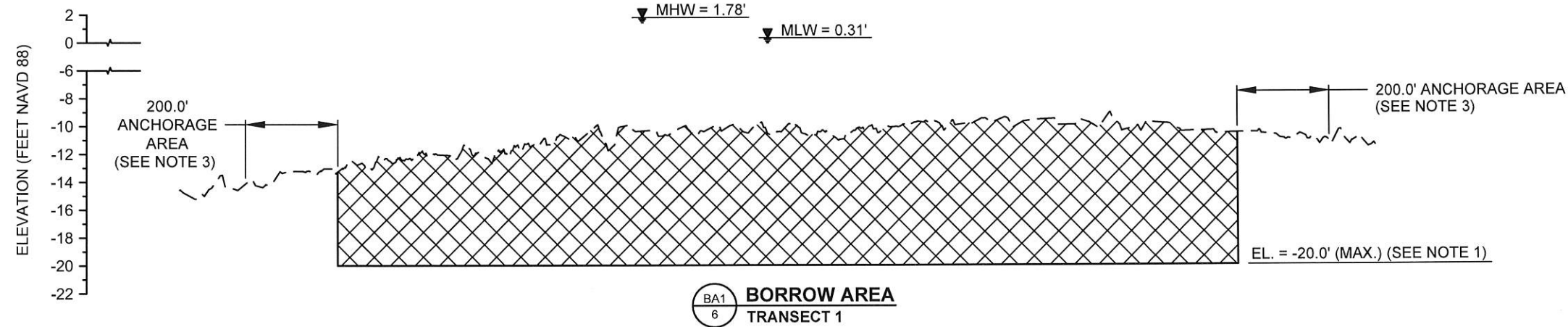

NOTE:

1. THE MAXIMUM DREDGING ELEVATION IS -20.0' INCLUDING THE OVERDREDGE AND DISTURBANCE AREA. THERE SHALL BE NO EXCAVATION OUTSIDE OF THE BORROW AREA SHOWN.
2. THE EXISTING GROUND IS BASED ON THE SURVEY PERFORMED IN SEPTEMBER TO NOVEMBER 2018.
3. THERE SHALL BE NO BOTTOM DISTURBING (ANCHORING, SPUDDING, ETC.) OUTSIDE OF THE ANCHORAGE AREA SHOWN.

STATE OF LOUISIANA  
KAZI SADID  
License No. 42398  
PROFESSIONAL ENGINEER  
CIVIL ENGINEERING  
08/18/2020

**LEGEND**  
 BORROW AREA  
 EXISTING GROUND

DATE: AUG 2020		<div>COASTAL PROTECTION AND RESTORATION AUTHORITY</div> <div>150 TERRACE AVENUE</div> <div>BATON ROUGE, LOUISIANA 70802</div>						
SHEET 9 OF 21	GRAND ISLE AND VICINITY: WEST END BEACH NOURISHMENT PROJECT			BORROW AREA TYPICAL SECTION				
	STATE PROJECT NUMBER: BA-0210			DESIGNED BY: K. SADID, P.E. P.E. NO. 42398				
	DRAWN BY: K. CANTU			APPROVED BY: R. SIMONEAUX, P.E.				
				REV.	DATE	DESCRIPTION		
						BY		





**SAND FENCE LAYOUT**

SAND FENCE (PARALLEL TO DUNE CENTERLINE)

TOE OF DUNE (EL. = 8.0' ± 0.5')

TOP OF DUNE (EL. = 13.0' ± 0.5')

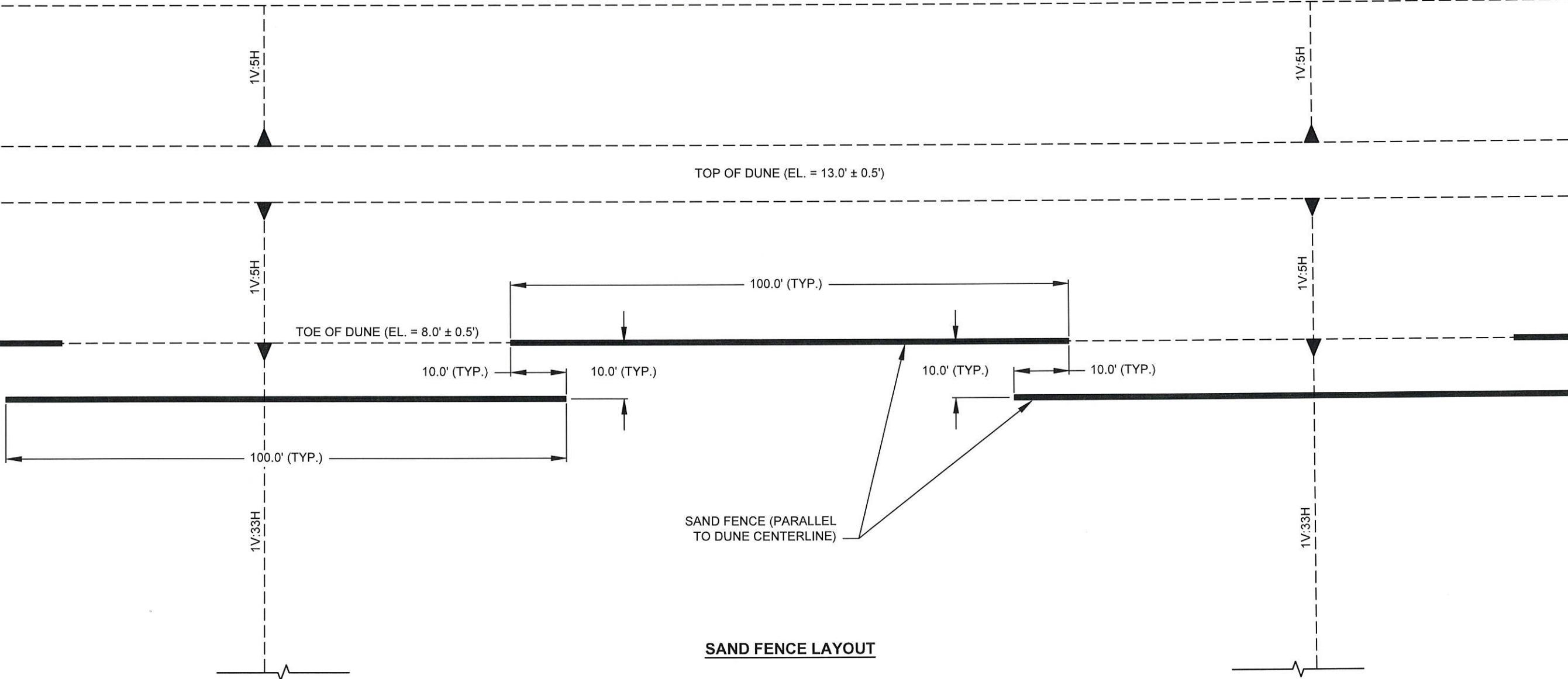

**NOTES:**

1. SAND FENCE SHALL BE PLACED ALONG THE ENTIRE LENGTH OF REPAIRED DUNE.
2. SAND FENCE SHALL NOT BE PLACED WITHIN 5 FEET OF VEHICLE AND PEDESTRIAN CROSSOVERS.
3. WHEREVER POSSIBLE, LOCATE THE OVERLAP SECTIONS OF SAND FENCE AT VEHICLE AND PEDESTRIAN CROSSOVERS TO MINIMIZE THE NUMBER OF DISRUPTIONS TO SAND FENCE SPACING.

GRAND ISLE AND VICINITY:  
WEST END BEACH  
NOURISHMENT PROJECT

SAND FENCE  
LAYOUT

COASTAL PROTECTION AND  
RESTORATION AUTHORITY

150 TERRACE AVENUE  
BATON ROUGE, LOUISIANA 70802

DATE: AUG. 2020

SHEET 10 OF 21

STATE PROJECT NUMBER: BA-0210

DESIGNED BY: KAZI SADID, P.E. P.E. NO. 42398

APPROVED BY: R. SIMONEAUX, P.E.

DRAWN BY: K. CANTU

REV.

DATE

DESCRIPTION

BY



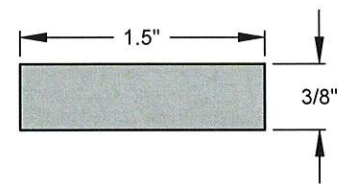

INDIVIDUAL SLAT  
TOP VIEW

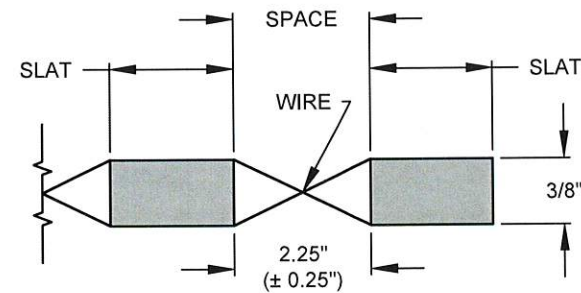

SLAT SPACING  
PLAN

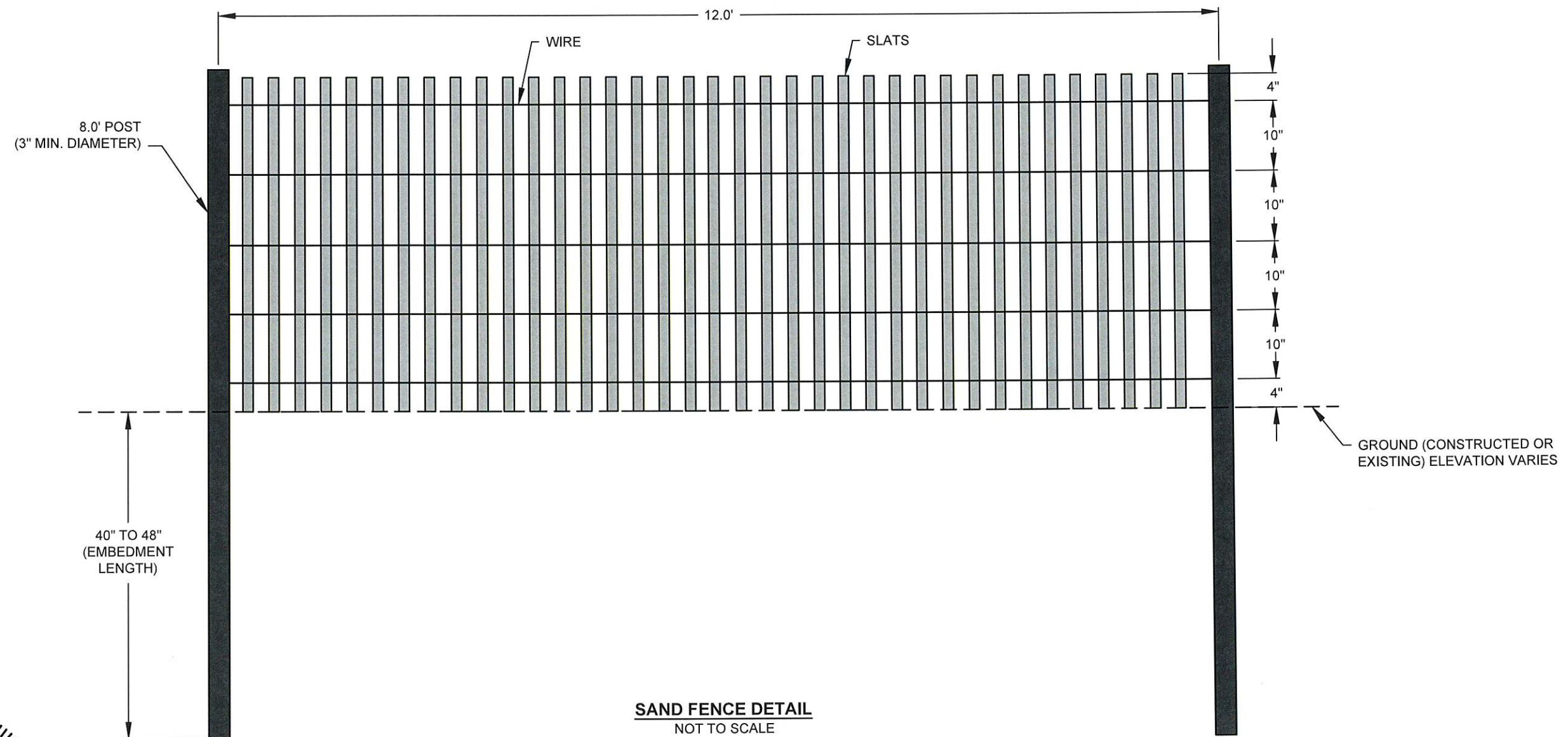

SAND FENCE DETAIL  
NOT TO SCALE

NOTES:

1. SLATS SHALL BE NO. 1 ASPEN OR SPRUCE.
2. WIRE SHALL NOT BE LESS THAN 13 STEEL WIRE GAUGE.
3. POSTS SHALL BE 8 FEET IN LENGTH AND PLACED 12 FEET ON CENTER.
4. SET POSTS PLUMB AND IN ALIGNMENT.
5. FENCING SHALL BE TIED TO THE POST USING TIE WIRE.



COASTAL PROTECTION AND  
RESTORATION AUTHORITY  
150 TERRACE AVENUE  
BATON ROUGE, LOUISIANA 70802

SAND FENCE  
DETAILS

GRAND ISLE AND VICINITY:  
WEST END BEACH  
NOURISHMENT PROJECT

DATE: AUG 2020

SHEET 11 OF 21

DESIGNED BY: KAZI SADID, P.E. P.E. 42398

APPROVED BY: R. SIMONEAUX, P.E.

STATE PROJECT NUMBER: BA-0210

DRAWN BY: K. CANTU

REV. DATE DESCRIPTION BY



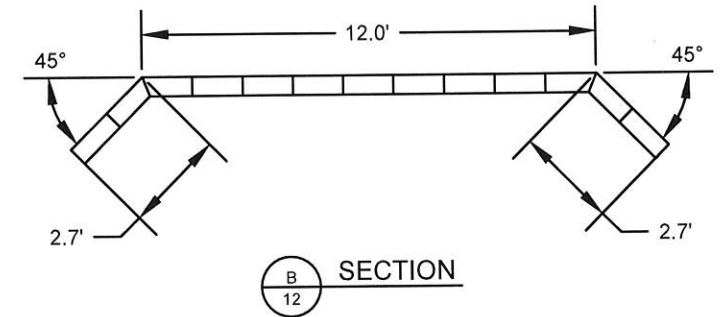
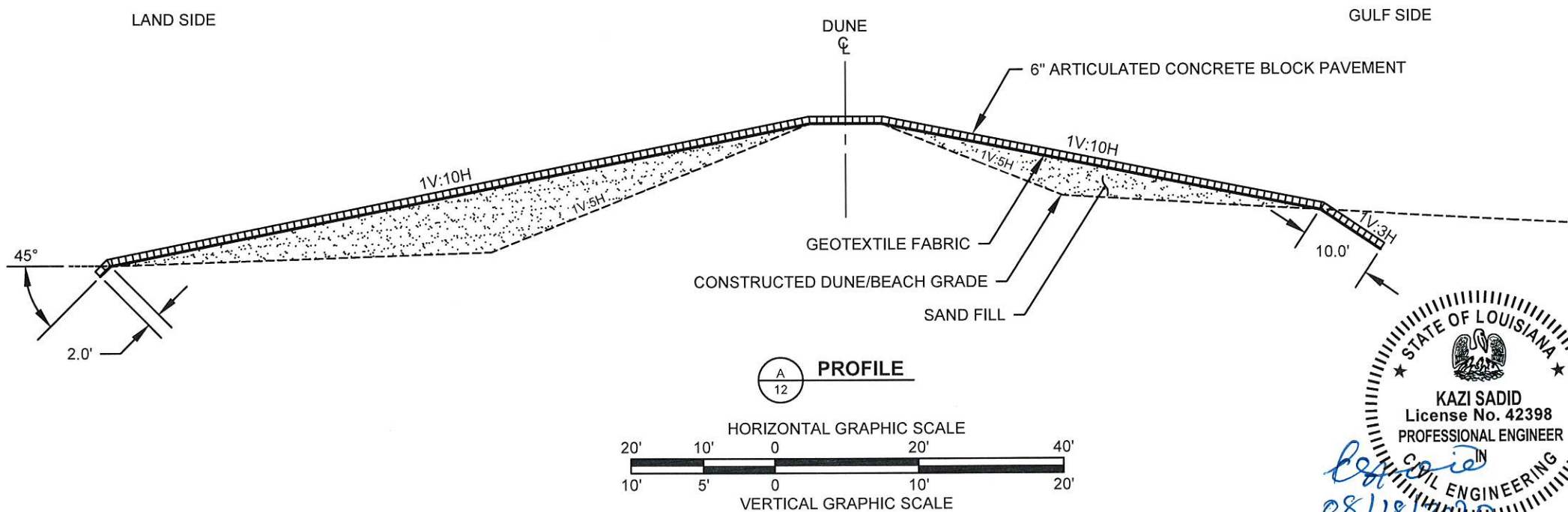
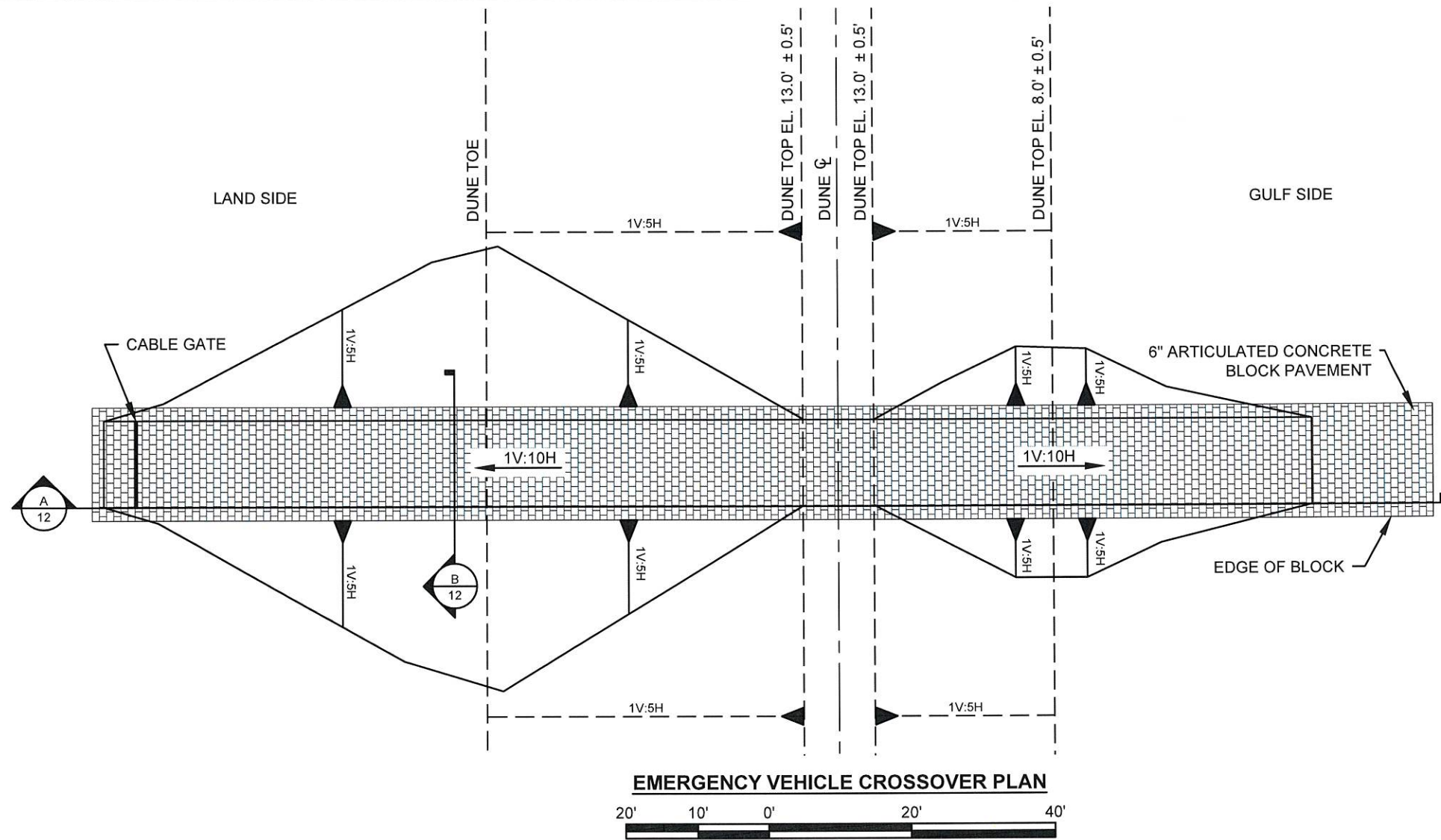

ARTICULATED CONCRETE BLOCK SPECIFICATIONS				
BLOCK NUMBER	WEIGHTS		UNIT COVERAGE SQ. FT.	OPEN AREA %
	UNIT WEIGHT LBS	SYSTEM WEIGHT LBS. PER SQ. FT.		
H-600-OC	45 - 53	45 - 53	1.0	25

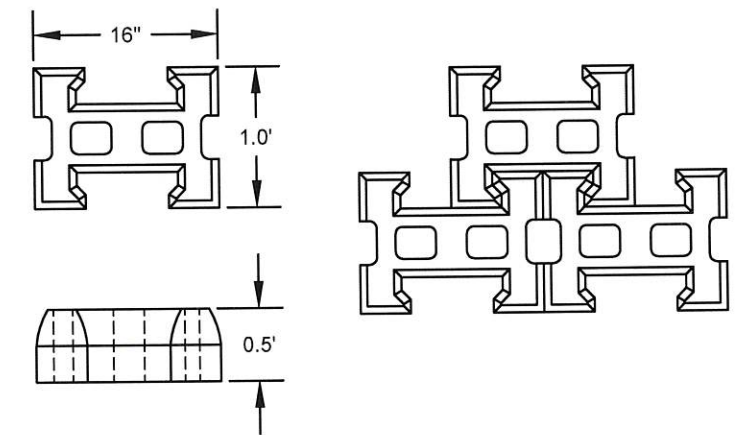

ARTICULATED CONCRETE BLOCK DETAIL  
NOT TO SCALE

- TECHNICAL SPECIFICATIONS:
- SHORELOC UNITS ARE MANUFACTURED IN ACCORDANCE WITH ASTM C90 AND THE FOLLOWING CRITERIA.
    - CONCRETE UNIT WEIGHT 13-150 LBS/CF
    - MINIMUM COMPRESSIVE STRENGTH - 4,000 PSI
    - MAXIMUM ABSORPTION - 7%
    - DIMENSIONAL TOLERANCE  $\pm 1/8"$

- NOTES:
- SHEET 5 SHOWS LOCATIONS OF EMERGENCY VEHICLE CROSSOVERS.
  - DETAIL SHOWN REPRESENTS RIGHT HAND ORIENTATION.
  - SLOPE ON LAND SIDE RAMP WILL BE VARIED AS NECESSARY TO STAY WITHIN EXISTING ROW AS DETERMINED BY ACTUAL FIELD CONDITIONS.



GRAND ISLE AND VICINITY; WEST END BEACH NOURISHMENT PROJECT		EMERGENCY VEHICLE CROSSOVER DETAILS		COASTAL PROTECTION AND RESTORATION AUTHORITY 150 TERRACE AVENUE BATON ROUGE, LOUISIANA 70802										
STATE PROJECT NUMBER: BA-0210		DESIGNED BY: KAZI SADID, P.E.						P.E. NO. 42398						
DRAWN BY: K. CANTU		APPROVED BY: R. SIMONEAUX, P.E.												
DATE: AUG. 2020														
SHEET 12 OF 21														



LAND SIDE

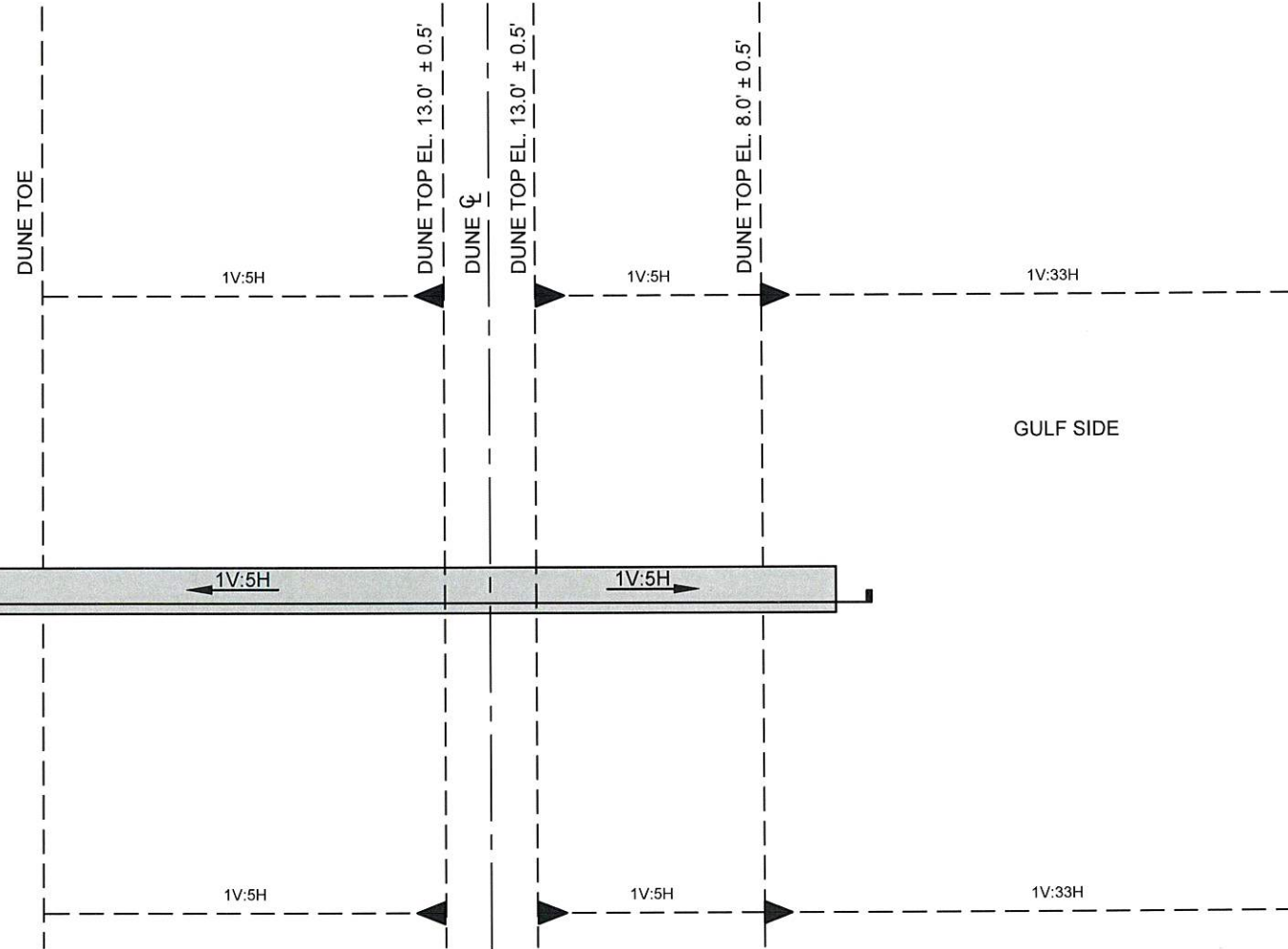

PEDESTRIAN CROSSOVER PLAN



LAND SIDE

GULF SIDE

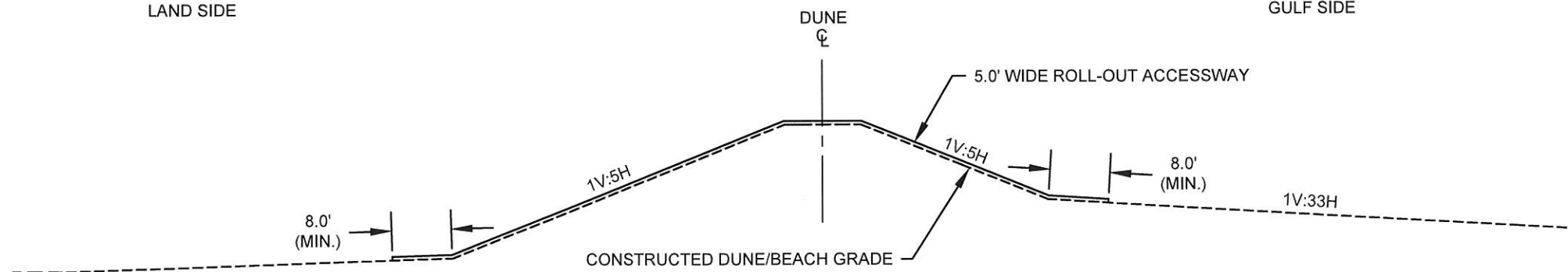

PROFILE

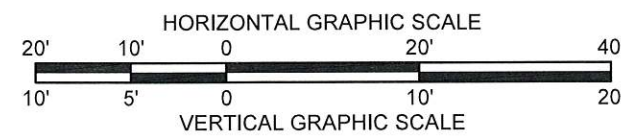

NOTES:

1. SHEET 5 SHOWS LOCATIONS OF PEDESTRIAN CROSSOVERS.
2. SLOPE ON LAND SIDE RAMP WILL BE VARIED AS NECESSARY TO STAY WITHIN EXISTING ROW AS DETERMINED BY ACTUAL FIELD CONDITIONS.
3. ROLL-OUT ACCESSWAY TO CONSIST OF SYNTHETIC MATTING OR WOODEN PLANKING, SEE SPECIFICATION FOR ADDITIONAL MATERIAL AND INSTALLATION REQUIREMENTS

COASTAL PROTECTION AND RESTORATION AUTHORITY  
150 TERRACE AVENUE  
BATON ROUGE, LOUISIANA 70802

PEDESTRIAN CROSSOVER DETAILS

GRAND ISLE AND VICINITY:  
WEST END BEACH  
NOURISHMENT PROJECT

DESIGNED BY: KAZI SADID, P.E. P.E. NO. 42398

APPROVED BY: R. SIMONEAUX, P.E.

STATE PROJECT NUMBER: BA-0210  
DRAWN BY: K. CANTU

DATE: AUG. 2020

SHEET 13 OF 21

BY

DESCRIPTION

DATE

REV.



EL. = 14.0'

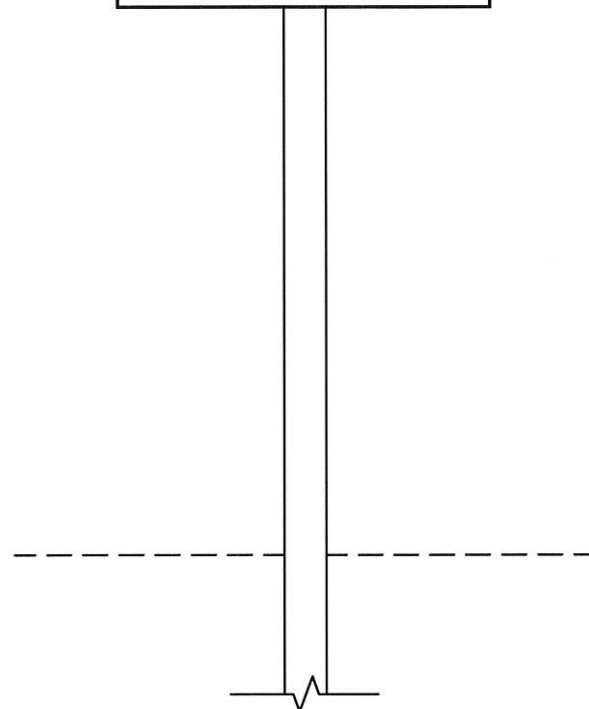

NO SWIMMING SIGN DETAIL  
NOT TO SCALE

EL. = 14.0'

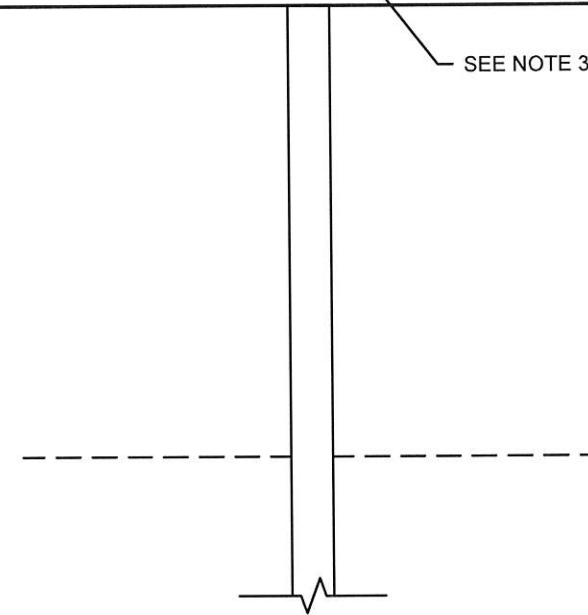

RIP TIDE SIGN DETAIL  
NOT TO SCALE

NOTES:

1. WARNING SIGNS SHALL BE CONSTRUCTED AND INSTALLED IN ACCORDANCE WITH SECTIONS 729, 812 AND 1014 OF THE LOUISIANA STANDARD SPECIFICATIONS FOR ROADS AND BRIDGES, AS PUBLISHED BY THE LADOTD, 2016 EDITION.
2. A SHOP DRAWING SHALL BE SUBMITTED TO THE ENGINEER FOR APPROVAL PRIOR TO FABRICATION OF THE MARKERS.
3. EMERGENCY CALLING INFORMATION TO THE POLICE OR LOCAL AUTHORITY WILL BE PROVIDED DURING CONSTRUCTION.



COASTAL PROTECTION AND RESTORATION AUTHORITY 150 TERRACE AVENUE BATON ROUGE, LOUISIANA 70802		WARNING SIGN DETAILS		DATE: AUG. 2020	
		DESIGNED BY: KAZI SADID, P.E.		SHEET 14 OF 21	
		P.E. NO. 42398			



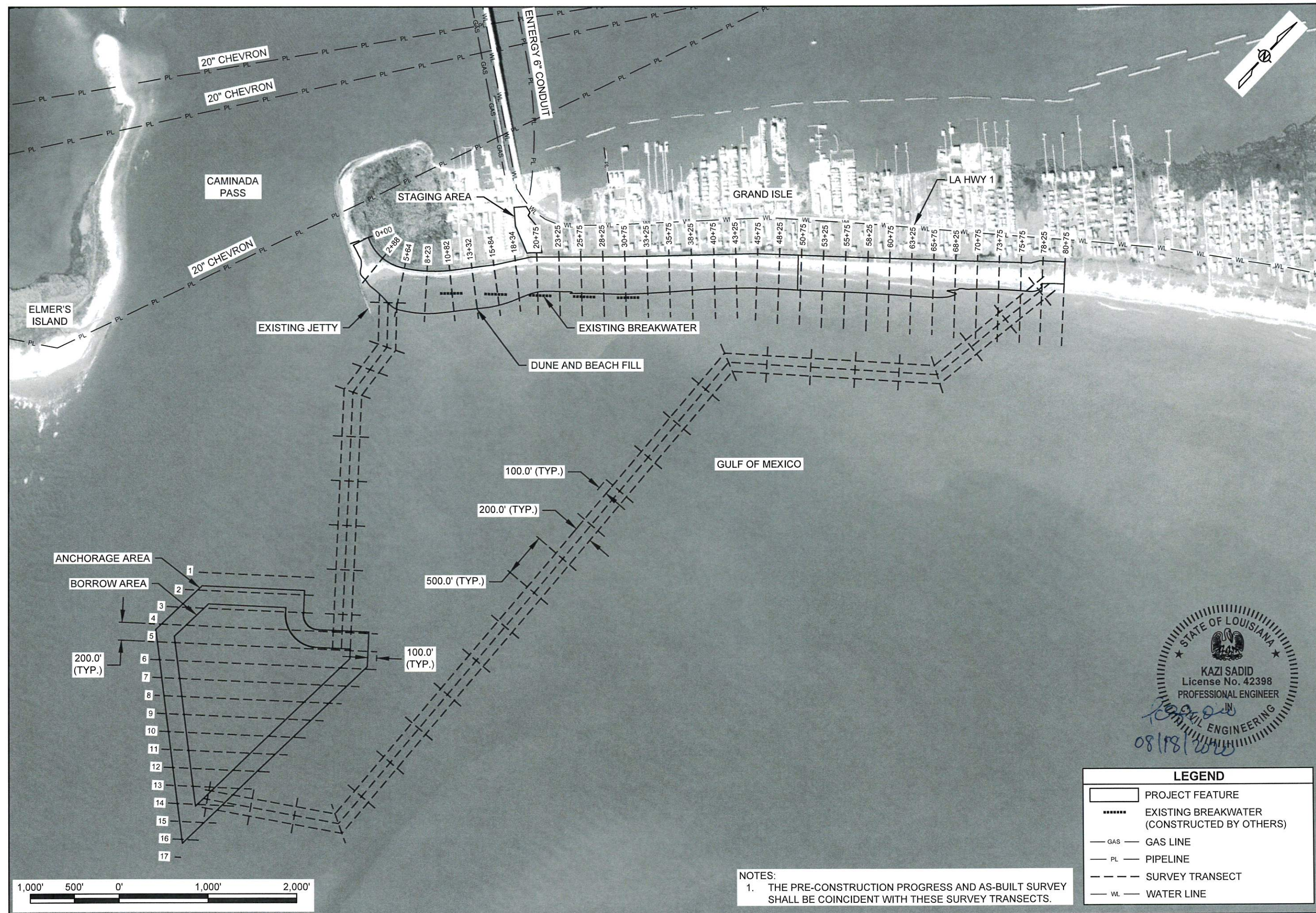

NOTES:  
1. THE PRE-CONSTRUCTION PROGRESS AND AS-BUILT SURVEY SHALL BE COINCIDENT WITH THESE SURVEY TRANSECTS.

DATE: AUG. 2020		CONSTRUCTION SURVEY LAYOUT		COASTAL PROTECTION AND RESTORATION AUTHORITY  150 TERRACE AVENUE BATON ROUGE, LOUISIANA 70802																																																																																																																																																																																																																																																																																																																																																																																																																																																																																																																																																																																																																																																																																																																																																																																																																																																																																																																																																																																																																																																																																																																																																																																																																																																																																																																																																																																																																																																																																																																																																																																																																																																																																																																																																										</
-----------------	--	-------------------------------	--	---	--	--	--	--	--	--	--	--	--	--	--	--	--	--	--	--	--	--	--	--	--	--	--	--	--	--	--	--	--	--	--	--	--	--	--	--	--	--	--	--	--	--	--	--	--	--	--	--	--	--	--	--	--	--	--	--	--	--	--	--	--	--	--	--	--	--	--	--	--	--	--	--	--	--	--	--	--	--	--	--	--	--	--	--	--	--	--	--	--	--	--	--	--	--	--	--	--	--	--	--	--	--	--	--	--	--	--	--	--	--	--	--	--	--	--	--	--	--	--	--	--	--	--	--	--	--	--	--	--	--	--	--	--	--	--	--	--	--	--	--	--	--	--	--	--	--	--	--	--	--	--	--	--	--	--	--	--	--	--	--	--	--	--	--	--	--	--	--	--	--	--	--	--	--	--	--	--	--	--	--	--	--	--	--	--	--	--	--	--	--	--	--	--	--	--	--	--	--	--	--	--	--	--	--	--	--	--	--	--	--	--	--	--	--	--	--	--	--	--	--	--	--	--	--	--	--	--	--	--	--	--	--	--	--	--	--	--	--	--	--	--	--	--	--	--	--	--	--	--	--	--	--	--	--	--	--	--	--	--	--	--	--	--	--	--	--	--	--	--	--	--	--	--	--	--	--	--	--	--	--	--	--	--	--	--	--	--	--	--	--	--	--	--	--	--	--	--	--	--	--	--	--	--	--	--	--	--	--	--	--	--	--	--	--	--	--	--	--	--	--	--	--	--	--	--	--	--	--	--	--	--	--	--	--	--	--	--	--	--	--	--	--	--	--	--	--	--	--	--	--	--	--	--	--	--	--	--	--	--	--	--	--	--	--	--	--	--	--	--	--	--	--	--	--	--	--	--	--	--	--	--	--	--	--	--	--	--	--	--	--	--	--	--	--	--	--	--	--	--	--	--	--	--	--	--	--	--	--	--	--	--	--	--	--	--	--	--	--	--	--	--	--	--	--	--	--	--	--	--	--	--	--	--	--	--	--	--	--	--	--	--	--	--	--	--	--	--	--	--	--	--	--	--	--	--	--	--	--	--	--	--	--	--	--	--	--	--	--	--	--	--	--	--	--	--	--	--	--	--	--	--	--	--	--	--	--	--	--	--	--	--	--	--	--	--	--	--	--	--	--	--	--	--	--	--	--	--	--	--	--	--	--	--	--	--	--	--	--	--	--	--	--	--	--	--	--	--	--	--	--	--	--	--	--	--	--	--	--	--	--	--	--	--	--	--	--	--	--	--	--	--	--	--	--	--	--	--	--	--	--	--	--	--	--	--	--	--	--	--	--	--	--	--	--	--	--	--	--	--	--	--	--	--	--	--	--	--	--	--	--	--	--	--	--	--	--	--	--	--	--	--	--	--	--	--	--	--	--	--	--	--	--	--	--	--	--	--	--	--	--	--	--	--	--	--	--	--	--	--	--	--	--	--	--	--	--	--	--	--	--	--	--	--	--	--	--	--	--	--	--	--	--	--	--	--	--	--	--	--	--	--	--	--	--	--	--	--	--	--	--	--	--	--	--	--	--	--	--	--	--	--	--	--	--	--	--	--	--	--	--	--	--	--	--	--	--	--	--	--	--	--	--	--	--	--	--	--	--	--	--	--	--	--	--	--	--	--	--	--	--	--	--	--	--	--	--	--	--	--	--	--	--	--	--	--	--	--	--	--	--	--	--	--	--	--	--	--	--	--	--	--	--	--	--	--	--	--	--	--	--	--	--	--	--	--	--	--	--	--	--	--	--	--	--	--	--	--	--	--	--	--	--	--	--	--	--	--	--	--	--	--	--	--	--	--	--	--	--	--	--	--	--	--	--	--	--	--	--	--	--	--	--	--	--	--	--	--	--	--	--	--	--	--	--	--	--	--	--	--	--	--	--	--	--	--	--	--	--	--	--	--	--	--	--	--	--	--	--	--	--	--	--	--	--	--	--	--	--	--	--	--	--	--	--	--	--	--	--	--	--	--	--	--	--	--	--	--	--	--	--	--	--	--	--	--	--	--	--	--	--	--	--	--	--	--	--	--	--	--	--	--	--	--	--	--	--	--	--	--	--	--	--	--	--	--	--	--	--	--	--	--	--	--	--	--	--	--	--	--	--	--	--	--	--	--	--	--	--	--	--	--	--	--	--	--	--	--	--	--	--	--	--	--	--	--	--	--	--	--	--	--	--	--	--	--	--	--	--	--	--	--	--	--	--	--	--	--	--	--	--	--	--	--	--	--	--	--	--	--	--	--	--	--	--	--	--	--	--	--	--	--	--	--	--	--	--	--	--	--	--	--	--	--	--	--	--	--	--	--	--	--	--	--	--	--	--	--	--	--	--	--	--	--	--	--	--	--	--	--	--	--	--	--	--	--	--	--	--	--	--	--	--	--	--	--	--	--	--	--	--	--	--	--	--	--	--	--	--	--	--	--	--	--	--	--	--	--	--	--	--	--	--	--	--	--	--	--	--	--	--	--	--	--	--	--	--	--	--	--	--	--	--	--	--	--	--	--	--	--	--	--	--	--	--	--	--	--	--	--	--	--	--	--	--	--	--	--	--	--	--	--	--	--	--	--	--	--	--	--	--	--	--	--	--	--	--	--	--	--	--	--	--	--	--	--	--	--	--	--	--	--	--	--	--	--	--	--	--	--	--	--	--	--	--	--	--	--	--	--	--	--	--	--	--	--	--	--	--	--	--	--	--	--	--	--	--	--	--	--	--	--	--	--	--	--	--	--	--	--	--	--	--	--	--	--	--	--	--	--	--	--	--	--	--	--	--	--	--	--	--	--	--	--	--	--	--	--	--	--	--	--	--	--	--	--	--	--	--	--	--	--	--	--	--	--	--	--	--	--	--	--	--	--	--	--	--	--	--	--	--	--	--	--	--	--	--	--	--	--	--	--	--	--	--	--	--	--	--	--	--	--	--	--	--	--	--	--	--	--	--	--	--	--	--	--	--	--	--	--	--	--	--	--	--	--	--	--	--	--	--	--	--	--	--	--	--	--	--	--	--	--	--	--	--	--	--	--	--	--	--	--	--	--	--	--	--	--	--	--	--	--	--	--	--	--	--	--	--	--	--	--	--	--	--	--	--	--	--	--	--	--	--	--	--	--	--	--	--	--	--	--	--	--	--	--	--	--	--	--	--	--	--	--	--	--	--	--	--	--	--	--	--	--	--	--	--	--	--	--	--	--	--	--	--	--	--	--	--	--	--	--	--	--	--	--	--	--	--	--	--	--	--	--	--	--	--	--	--	--	--	--	--	--	--	--	--	--	--	--	--	--	--	--	--	--	--	--	--	--	--	--	--	--	--	--	--	--	--	--	--	--	--	--	--	--	--	--	--	--	--	--	--	--	--	--	--	--	--	--	--	--	--	--	--	--	--	--	--	--	--	--	--	--	--	--	--	--	--	--	--	--	--	--	--	--	--	--	--	--	--	--	--	--	--	--	--	--	--	--	--	--	--	--	--	--	--	--	--	--	--	--	--	--	--	--	--	--	--	--	--	--	--	--	--	--	--	--	--	--	--	--	--	--	--	--	--	--	--	--	--	--	--	--	--	--	--	--	--	--	--	--	--	--	--	--	--	--	--	--	--	--	--	--	--	--	--	--	--	--	--	--	--	--	--	--	--	--	--	--	--	--	--	--	--	--	--	--	--	--	--	--	--	--	--	--	--	--	--	--	--	--	--	--	--	--	--	--	--	--	--	--	--	--	--	--	--	--	--	--	--	--	--	--	--	--	--	--	--	--	--	--	--	--	--	--	--	--	--	--	--	--	--	--	--	--	--	--	--	--	--	--	--	--	--	--	--	--	--	--	----



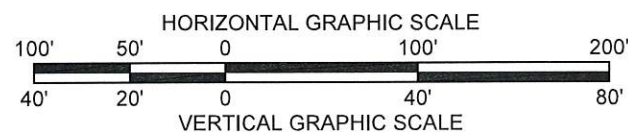
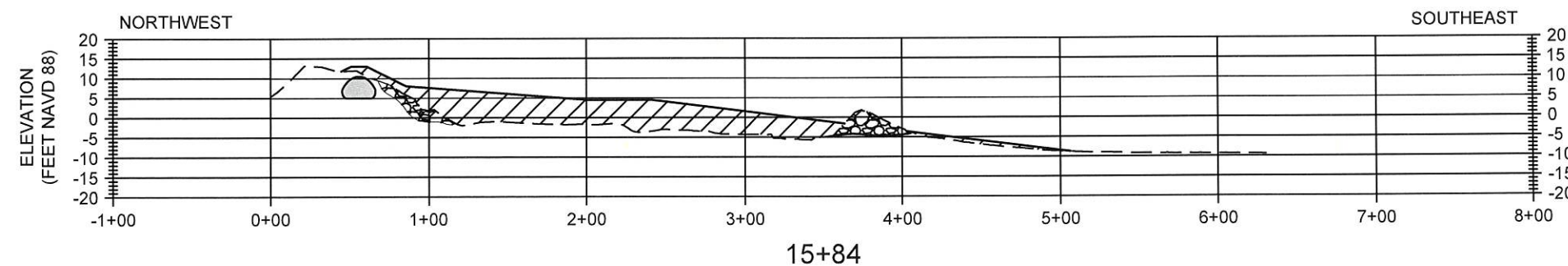
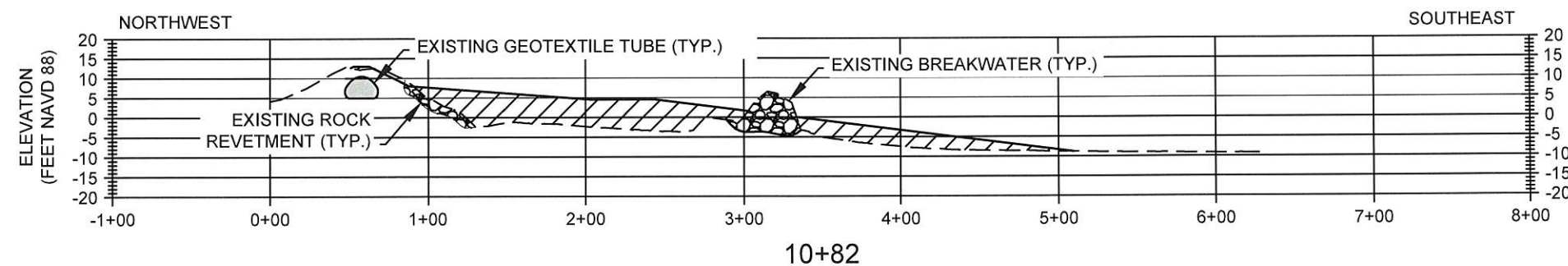
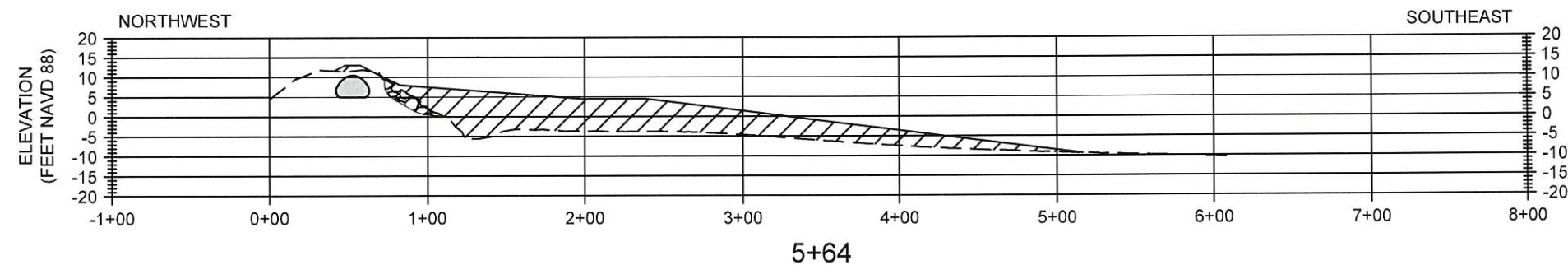
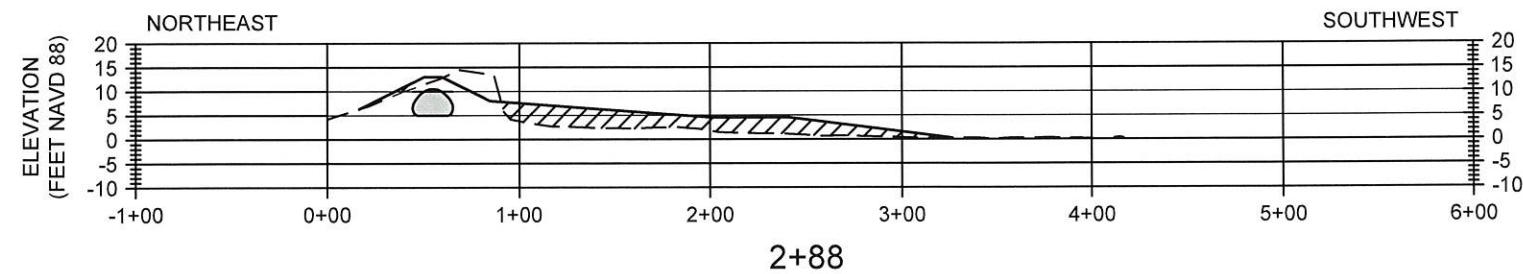
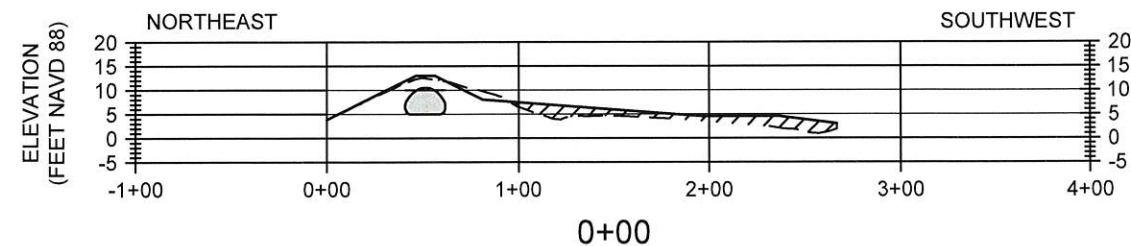

- NOTES:
1. THE POSITION AND SIZE OF THE GEOTEXTILE TUBE ARE APPROXIMATE AND SHOWN FOR VISUALIZATION PURPOSES ONLY.
  2. THE EXISTING GROUND IS BASED ON THE SURVEY PERFORMED IN JUNE 2020.



LEGEND	
	DUNE AND BEACH FILL
	EXISTING ROCK STRUCTURE
	EXISTING GROUND
	EXISTING GEOTEXTILE TUBE

COASTAL PROTECTION AND RESTORATION AUTHORITY 150 TERRACE AVENUE BATON ROUGE, LOUISIANA 70802		REV.	DATE	DESCRIPTION	BY
DUNE AND BEACH SECTIONS	DESIGNED BY: KAZI SADID, P.E. P.E. NO. 42398 APPROVED BY: R. SIMONEAUX, P.E.				
GRAND ISLE AND VICINITY: WEST END BEACH NOURISHMENT PROJECT	STATE PROJECT NUMBER: BA-0210 DRAWN BY: K. CANTU				
		DATE: AUG. 2020			
		SHEET 16 OF 21			



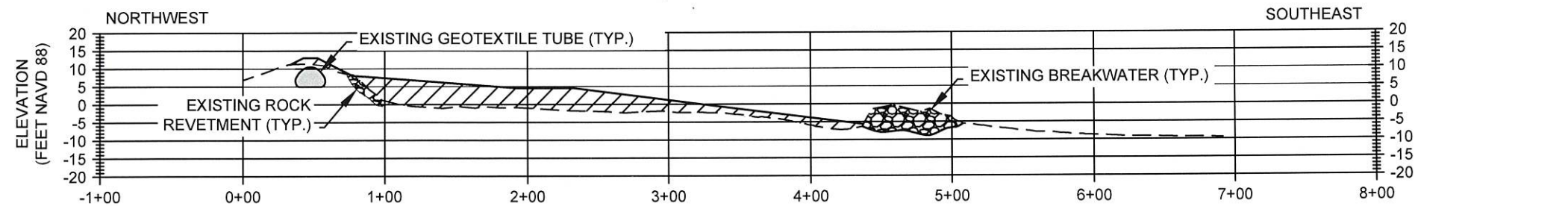

20+75

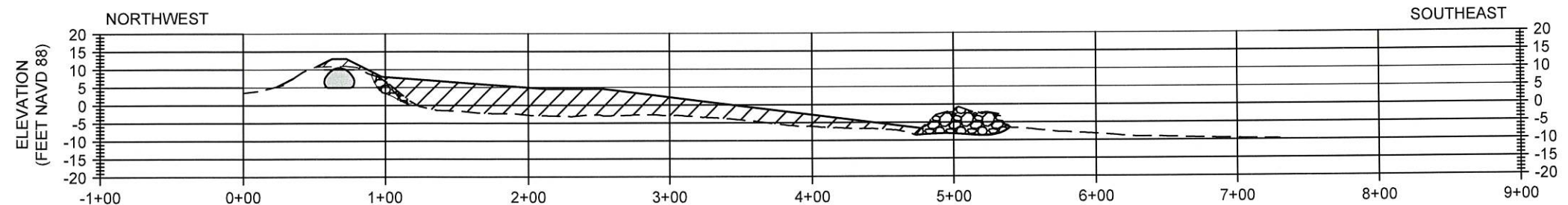

25+75

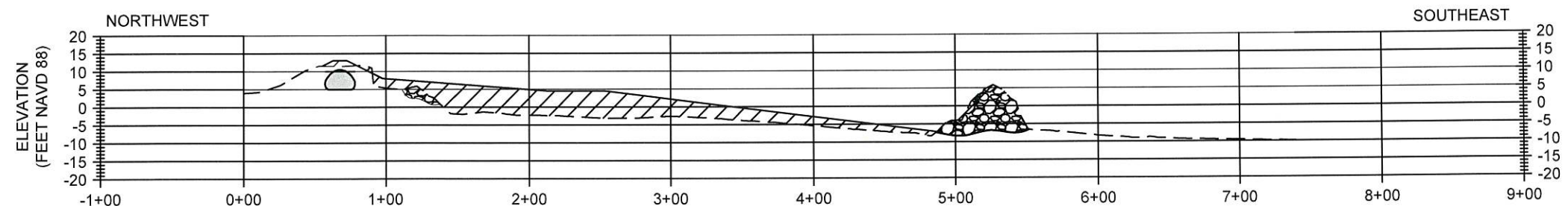

30+75

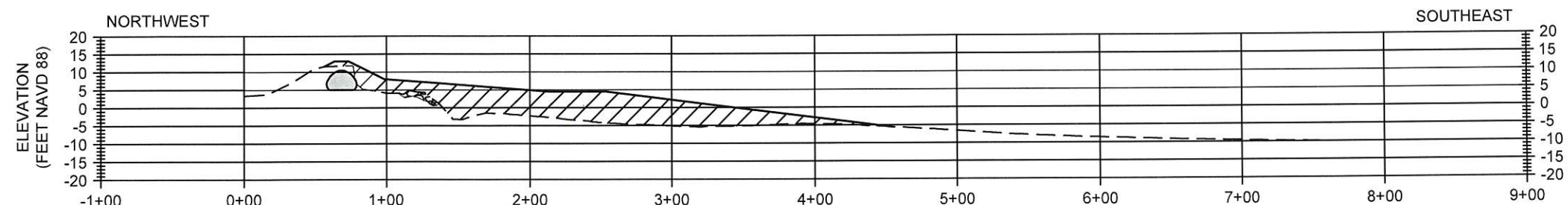

35+75

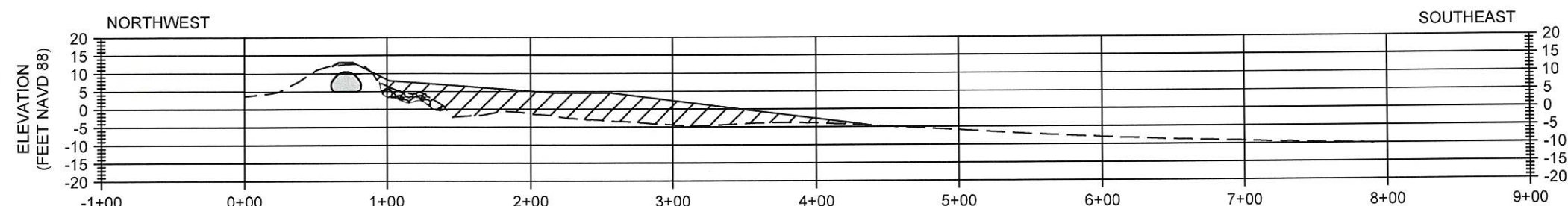

40+75

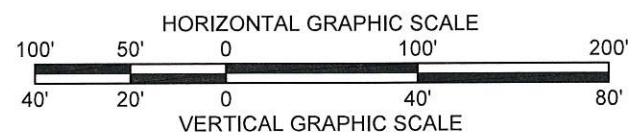

- NOTES:
1. THE POSITION AND SIZE OF THE GEOTEXTILE TUBE ARE APPROXIMATE AND SHOWN FOR VISUALIZATION PURPOSES ONLY.
  2. THE EXISTING GROUND IS BASED ON THE SURVEY PERFORMED IN JUNE 2020.



LEGEND	
	DUNE AND BEACH FILL
	EXISTING ROCK STRUCTURE
	EXISTING GROUND
	EXISTING GEOTEXTILE TUBE

COASTAL PROTECTION AND RESTORATION AUTHORITY 150 TERRACE AVENUE BATON ROUGE, LOUISIANA 70802		REV.	DATE	DESCRIPTION	BY
DUNE AND BEACH SECTIONS		DESIGNED BY: KAZI SADID, P.E. P.E. NO. 42398			
		APPROVED BY: R. SIMONEAUX, P.E.			
WEST END BEACH NOURISHMENT PROJECT		STATE PROJECT NUMBER: BA-0210			
		DRAWN BY: K. CANTU			
		DATE: AUG. 2020			
		SHEET 17 OF 21			



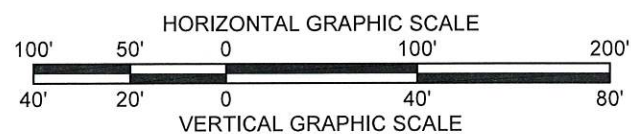
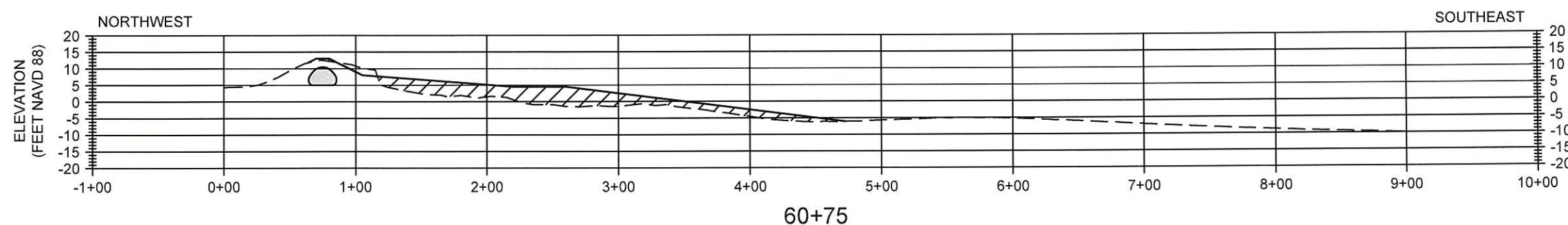
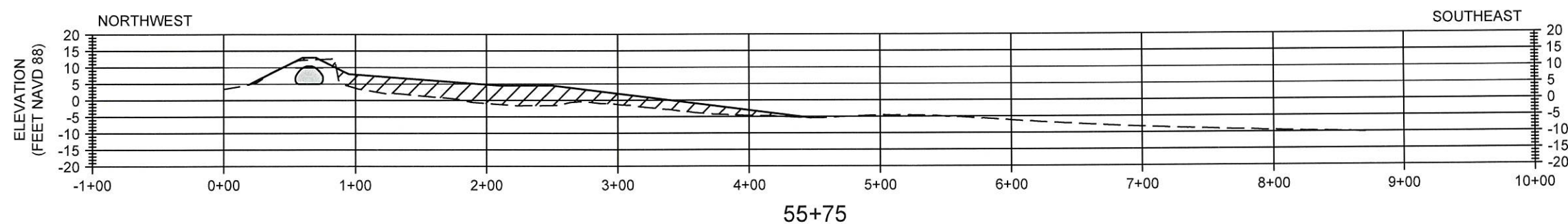
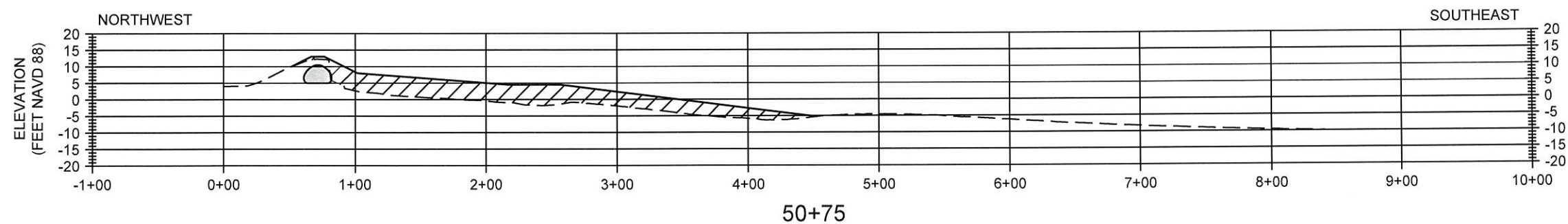
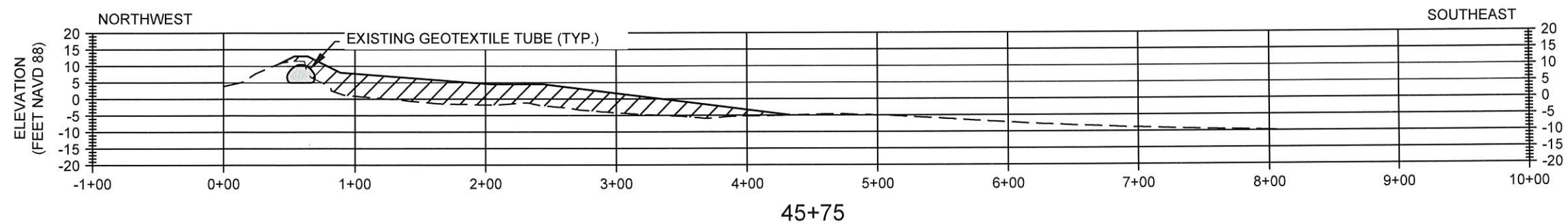

- NOTES:
1. THE POSITION AND SIZE OF THE GEOTEXTILE TUBE ARE APPROXIMATE AND SHOWN FOR VISUALIZATION PURPOSES ONLY.
  2. THE EXISTING GROUND IS BASED ON THE SURVEY PERFORMED IN JUNE 2020.

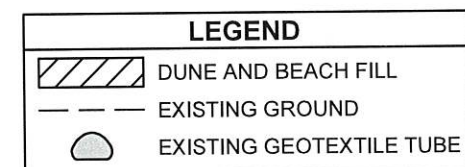
[illegible]



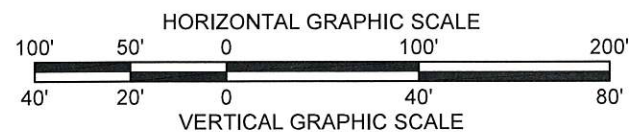
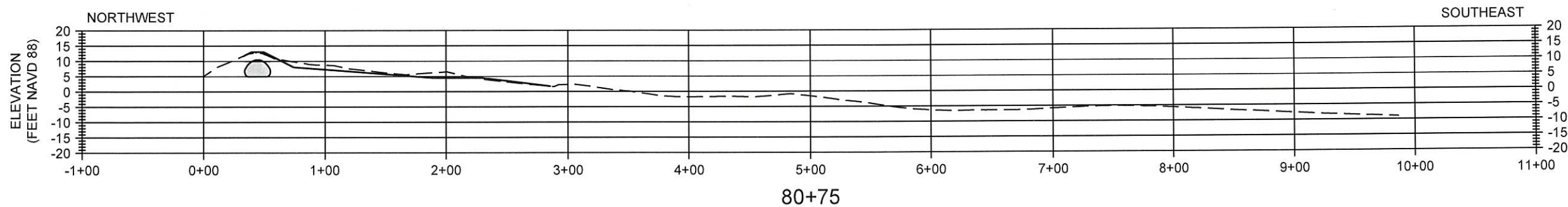
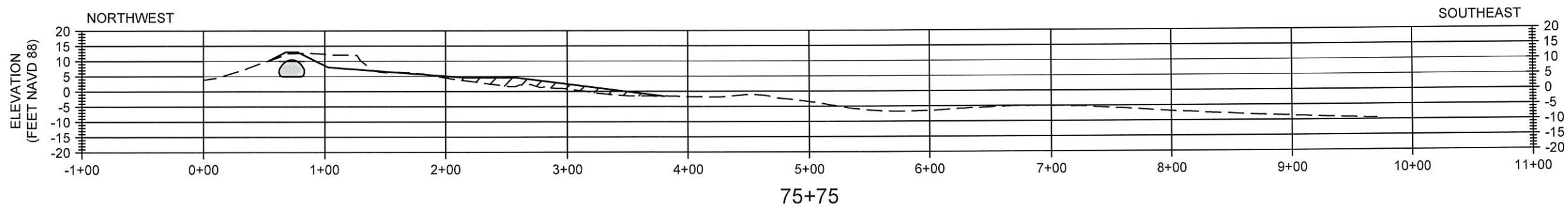
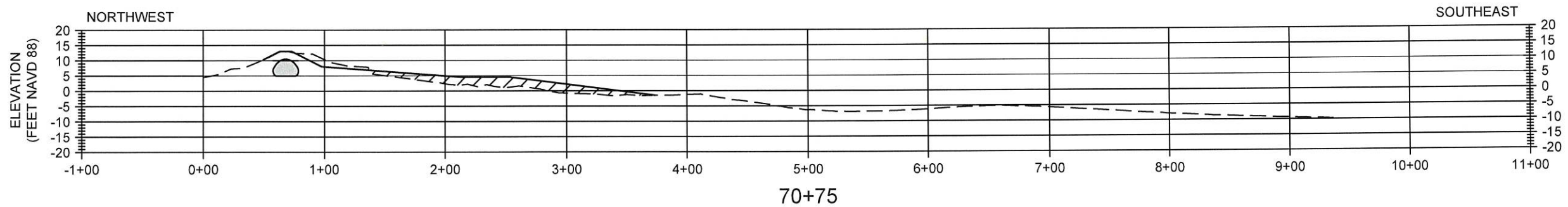
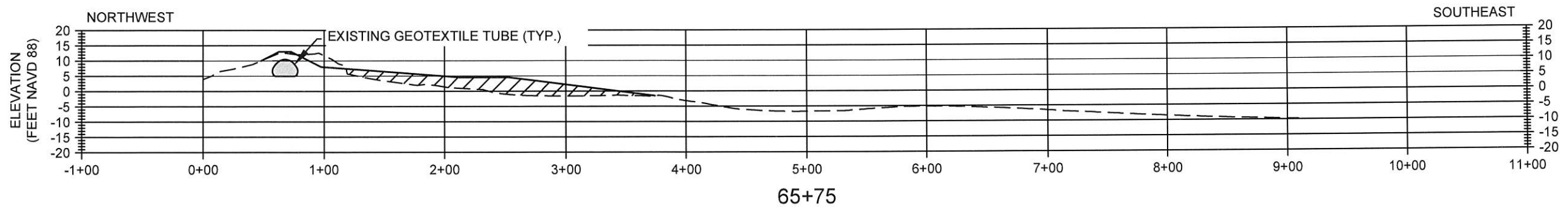

- NOTES:
1. THE POSITION AND SIZE OF THE GEOTEXTILE TUBE ARE APPROXIMATE AND SHOWN FOR VISUALIZATION PURPOSES ONLY.
  2. THE EXISTING GROUND IS BASED ON THE SURVEY PERFORMED IN JUNE 2020.

LEGEND	
	DUNE AND BEACH FILL
	EXISTING GROUND
	EXISTING GEOTEXTILE TUBE

COASTAL PROTECTION AND RESTORATION AUTHORITY 150 TERRACE AVENUE BATON ROUGE, LOUISIANA 70802	REV.	DATE	DESCRIPTION	BY
DUNE AND BEACH SECTIONS	DESIGNED BY:	KAZI SADID, P.E.	P.E. NO. 42398	
	APPROVED BY:	R. SIMONEAUX, P.E.		
	STATE PROJECT NUMBER:	BA-0210		
	DRAWN BY:	K. CANTU		
GRAND ISLE AND VICINITY: WEST END BEACH NOURISHMENT PROJECT	DATE: AUG. 2020			
	SHEET 19 OF 21			



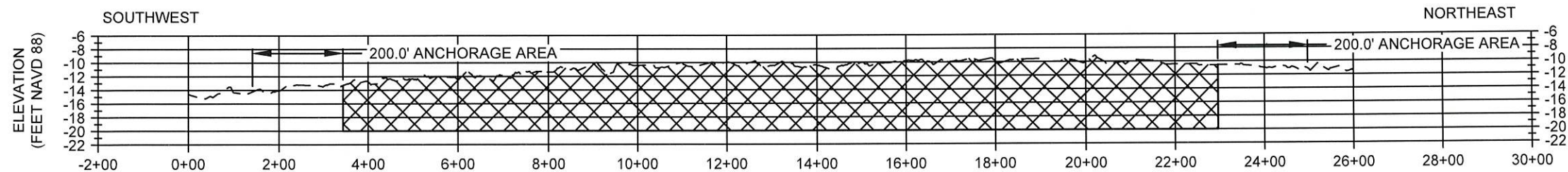

1

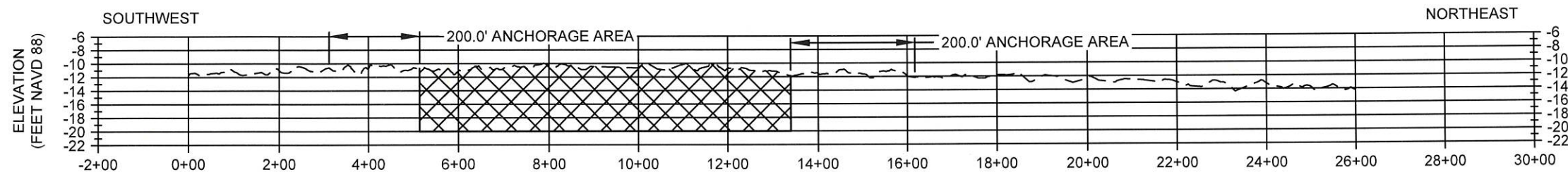

2

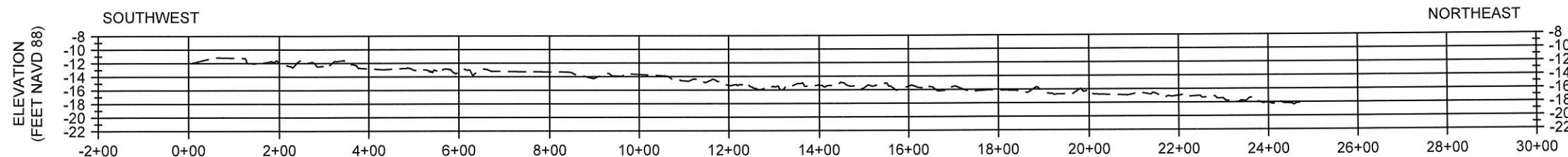

3

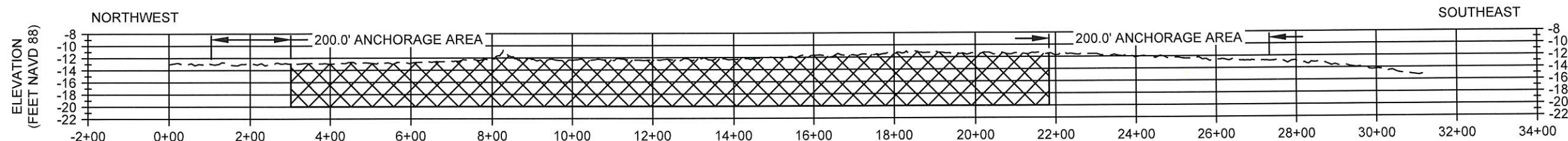

4

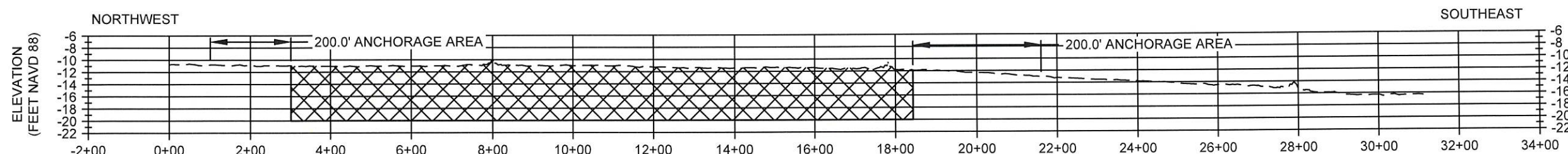

5

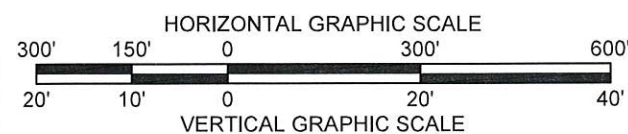

NOTES:  
1. EXISTING GROUND IS BASED ON THE SURVEY PERFORMED IN SEPTEMBER TO NOVEMBER 2018.

LEGEND	
	BORROW AREA
	EXISTING GROUND

DATE: AUG. 2020		BORROW AREA SECTIONS		COASTAL PROTECTION AND RESTORATION AUTHORITY 150 TERRACE AVENUE BATON ROUGE, LOUISIANA 70802					
SHEET 20 OF 21		GRAND ISLE AND VICINITY: WEST END BEACH NOURISHMENT PROJECT							
STATE PROJECT NUMBER: BA-0210		DESIGNED BY: KAZI SADID, P.E.							
APPROVED BY: R. SIMONEAUX, P.E.		P.E. NO. 42398							
						REV.	DATE	DESCRIPTION	BY



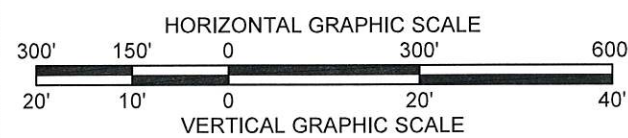
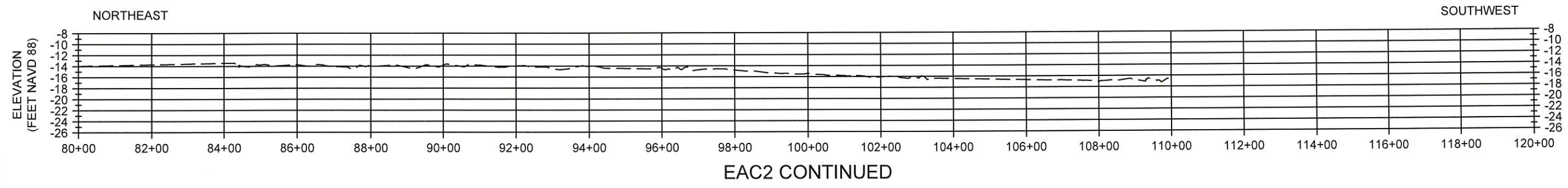
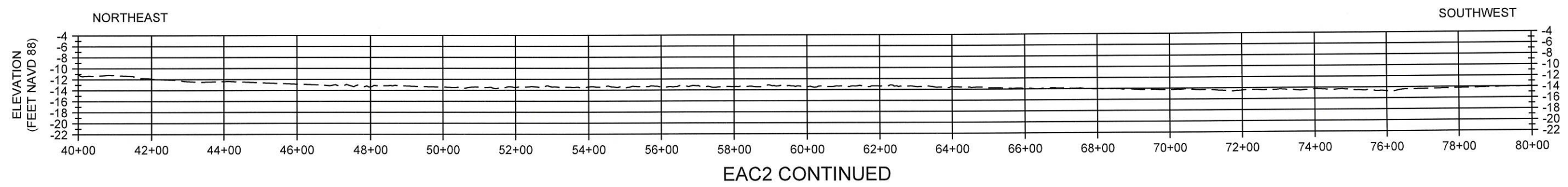
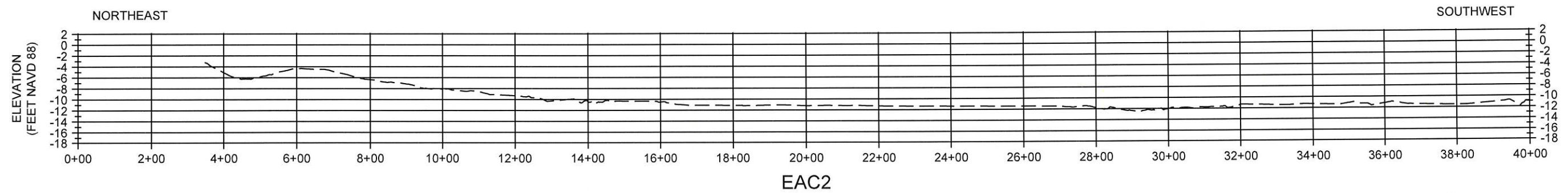
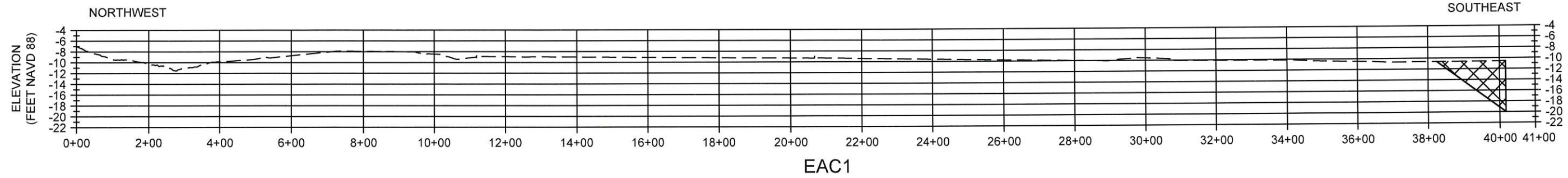

NOTES:

1. EXISTING GROUND IS BASED ON THE SURVEY PERFORMED IN SEPTEMBER TO NOVEMBER 2018.

LEGEND	
	BORROW AREA
	EXISTING GROUND

COASTAL PROTECTION AND RESTORATION AUTHORITY 150 TERRACE AVENUE BATON ROUGE, LOUISIANA 70802		REV.	DATE	DESCRIPTION	BY			
EQUIPMENT ACCESS CORRIDOR SECTIONS	DESIGNED BY: KAZI SADID, P.E.	P.E. NO. 42398						
	APPROVED BY: R. SIMONEAUX, P.E.							
GRAND ISLE AND VICINITY: WEST END BEACH NOURISHMENT PROJECT	STATE PROJECT NUMBER: BA-0210							
	DRAWN BY: K. CANTU							
DATE: AUG. 2020								
SHEET 21 OF 21								